

***Karon Skinner Catrone***  
***63 Gilbert Drive***  
***Stoughton, MA 02072***

---

April 21, 2023

Ms. Becca Solomon  
Conservation Agent  
Ashland Conservation Commission  
101 Main Street  
Ashland, MA 01721

**RE: Notice of Intent – 34 High Street, Ashland, MA 01721**

Dear Ms. Solomon:

Enclosed please find one (1) copy of a Notice of Intent (NOI) and site plan submittal on behalf of Daniel and Meredith Huff. The NOI is being filed under the Massachusetts Wetland Protection Act and the Ashland Wetland Protection Bylaw. This submittal includes:

1. Cover page
2. Wetland Protection Act Form 3 – Notice of Intent
3. Project Narrative
4. Natural Heritage and Endangered Species data
5. USGS data
6. Other associated documents
7. Site Plan

The applicant is proposing the construction of a bio retention area and a portion of an in-ground pool within the 100 foot buffer zone. A copy of this filing has been sent to the Northeast Regional Office of the Department of Environmental Protection. Please feel free to contact me at 508-668-4401 with any questions or concerns.

Sincerely,



Karon Skinner Catrone  
Wetland Consultant

## Town of Ashland Conservation Commission

### LOCAL FILING FEE CALCULATION WORKSHEET

#### 1. NOTICE OF INTENT (NOI)

<b>C1: Work on Existing Single Family Lot</b> This includes pools, additions, etc.	\$110.00	<u>\$ 110.00</u>
<b>C2: Construction of Single Family House, Crossings for Driveways, etc.</b>	\$500.00	_____
<b>C3: Commercial Building, Road Construction, etc.</b>	\$1050.00	_____
<b>C4: Crossings for Development or Commercial Road, Bridge, etc.</b>	\$1450.00	_____
<b>C5: Work on Docks, Piers, Dikes, or other Engineering Structures in inland resource areas</b>	_____	*\$4= _____ <small>Linear Feet</small>
<b>C6: Resource Area Delineation Review</b> Includes boundary delineations for vegetated wetlands as part of a permit application (ANRAD/ RDA with delineations/ NOI with delineations)	_____	*\$2= _____ <small>Linear Feet</small>
*single family lots limited to \$200; \$2000 limit for all others		
 <b>All NOIs add 50% of the fee for work in Riverfront Area</b>	 _____	 *\$.5= _____ <small>Above Fee</small>

#### 2. STORMWATER MANAGEMENT PERMIT

Basic Residential Application	\$100.00	_____
Application for Residential Subdivision or Multifamily Development	\$500.00	_____
Commercial Application	\$750.00	_____
Notice of Completion for Non-Basic Residential	\$150.00	_____
Permit Extension	\$150.00	_____

<b>True Copy Attest</b>	\$50.00	_____
<b>Re-Inspection</b>	\$50.00	_____

**3. OTHER PERMITS AND APPLICATIONS**

<b>Request for Determination of Applicability</b> Without boundary delineation	\$125.00	_____
<b>Request for Permit Extension</b> Not for Stormwater Management Permits	\$100.00	_____
<b>Amended Notice of Intent</b> Significant Revisions	SEE NOI	_____
<b>Certificate of Compliance</b> Without boundary delineation	Single Family Lots \$100.00 All Other Projects \$250.00	_____ _____
<b>Reissuance/ True Copy Attest</b> Not for Stormwater Management Permits	\$50.00	_____

**6. FILING FEE CALCULATION**

<b>Town Share of State Fees</b> (See NOI Wetland Fee Transmittal Form) (Check No. 1)	\$ <u>67<sup>50</sup></u>
<b>Local Filing Fee Calculated Above</b> (Check No.2)	\$ <u>110.00</u>
<b>State Share of Filing Fee</b> (See NOI Wetland Fee Transmittal Form)	
<b>TOTAL Due DEP</b> (Check No. 3)	\$ <u>42<sup>50</sup></u>

**7. ADVERTISING FEE (Paid by phone to newspaper) TBD**  
The fee will be the exact amount the newspaper charges for that specific advertisement. Once the advertisement is placed with the paper by the Conservation Commission, the applicant will be notified of the cost and will be expected to contact the newspaper for payment within the specified deadline.



# Town of Ashland

MASSACHUSETTS

## CONSERVATION COMMISSION Applicant Checklist for NOI/ANRAD/ANOI

This checklist is meant as guide when preparing a permit application during the State of Emergency, which was declared on March 12, 2020. This process shall remain in effect during the State of Emergency and will terminate when the State of Emergency is lifted. Note that submittal dates remain in effect.

1.  **Application**- submit 2 paper copies and 1 digital copy of all materials, and 1 Stormwater Management Checklist, if applicable. No spiral bindings!
2.  **Narrative**- 1 copy of a written narrative explaining existing conditions, proposed conditions, wetland resource areas on site (protected under the Act (310 CMR 10.02 (1) and the Bylaw (chapter 280)), the 100 foot Buffer Zone, the 25' No Disturb Zone and vernal pools
3.  **Locus Map**- 1 copy
4.  **Site Plans**- (folded) 1 large copy, and 1 (one) 11"x17" copy, if all details can be read.  
Plans must show the following:
  - a.  Existing Conditions
  - b.  Proposed Conditions
  - c.  Erosion Control Barrier- where it will be installed and a detail of the barrier to be used (note, no hay bales!)
  - d.  All wetland resource areas (see item 2 above)
  - e.  Endangered Species Habitat *N/A*
5.  **Application Fees**
  - a.  Wetland Fee Transmittal Form -- 1 Copy
  - b.  One check to the Commonwealth: 1 copy, see 310 CMR 10.03 (7)(c) to determine the category. Once the category is confirmed, see 310 CMR 4.10 (8) (n)4. for the fee amount.
  - c.  One check to the Town of Ashland for the town share of the fee under the Wetlands Protection Act. 2 copies
  - d.  A second check to the Town of Ashland for the bylaw fee: 2 Copies (c. 348-2)
6.  **Make an extra copy of everything from 1-5 and Submit your Application:**
  - a.  State: Electronically submit the application, locus map, narrative and site plans to DEP using [eDEP](#).

- b.  **State Fee:** Submit the state check, transmittal fee form, and photocopy of the town checks to Dept. of Environmental Protection, PO. Box. 4062, Boston, MA. 02211
  - c.  **Conservation Commission:** 101 Main Street, Ashland MA. 01721.c All documents listed above, as well as a pdf as indicated below, and to [conservation@ashlandmass.com](mailto:conservation@ashlandmass.com).
7.  For items 1-5, provide a pdf of everything, and CAD Files georeferenced to State Plane NAD 83 ft., if applicable, and send it to [conservation@ashlandmass.com](mailto:conservation@ashlandmass.com)
8.  **Receive hearing date and time information** from the Conservation Agent, and receive a date and time for a pre-hearing site visit.
9.  **Legal Notice.** The Conservation Commission posts the legal notice. The applicant will get billed by Gatehouse Media.
10.  **Notify Abutters** within 7 business days (no weekends or holidays).
- a.  Obtain a Certified List of Abutters from the Assessor's Office
  - b.  Notify abutters (certified mailing or hand delivery only) of the hearing date and time using the Commission's template and fill out an Affidavit of Service.
  - c.  Mail the proof of Mailing to the Ashland Town Hall, at 101 Main Street. Note that it must be received before the scheduled meeting date. You can drop it off in the grey box located on the side of Town Hall.
11.  **Attend the Zoom Meeting.**



Massachusetts Department of Environmental Protection  
Bureau of Resource Protection - Wetlands

**WPA Form 3 – Notice of Intent**

Massachusetts Wetlands Protection Act M.G.L. c. 131, §40

Provided by MassDEP:

MassDEP File Number

Document Transaction Number

Ashland

City/Town

**Important:**  
When filling out forms on the computer, use only the tab key to move your cursor - do not use the return key.



**Note:**  
Before completing this form consult your local Conservation Commission regarding any municipal bylaw or ordinance.

**A. General Information**

**1. Project Location (Note: electronic filers will click on button to locate project site):**

34 High Street Ashland 01721  
a. Street Address b. City/Town c. Zip Code

Latitude and Longitude: \_\_\_\_\_  
d. Latitude e. Longitude

Map 13.0 lot 163.0  
f. Assessors Map/Plat Number g. Parcel /Lot Number

**2. Applicant:**

Matt Labrie  
a. First Name b. Last Name

\_\_\_\_\_  
c. Organization  
280 Moody Street  
d. Street Address

Waltham MA 02453  
e. City/Town f. State g. Zip Code

508-304-5409 \_\_\_\_\_  
h. Phone Number i. Fax Number j. Email Address

**3. Property owner (required if different from applicant):**  Check if more than one owner

Daniel and Meredith \_\_\_\_\_  
a. First Name b. Last Name

\_\_\_\_\_  
c. Organization  
34 High Street  
d. Street Address

Ashland \_\_\_\_\_  
e. City/Town f. State g. Zip Code

203-631-0158 \_\_\_\_\_  
h. Phone Number i. Fax Number j. Email address

**4. Representative (if any):**

Karon Skinner Catrone  
a. First Name b. Last Name

\_\_\_\_\_  
c. Company  
63 Gilbert Drive  
d. Street Address

Stoughton MA 02072  
e. City/Town f. State g. Zip Code

781-341-0714 \_\_\_\_\_  
h. Phone Number i. Fax Number j. Email address

**5. Total WPA Fee Paid (from NOI Wetland Fee Transmittal Form):**

\$110.00 \$42.50 \$67.50  
a. Total Fee Paid b. State Fee Paid c. City/Town Fee Paid



**Massachusetts Department of Environmental Protection**  
 Bureau of Resource Protection - Wetlands  
**WPA Form 3 – Notice of Intent**  
 Massachusetts Wetlands Protection Act M.G.L. c. 131, §40

Provided by MassDEP:

---

MassDEP File Number

---

Document Transaction Number

---

Ashland

---

City/Town

**A. General Information (continued)**

6. General Project Description:

The applicant is proposing the construction of a bioretention area and a portion of an in-ground pool within the 100 foot buffer zone. All work is proposed outside the 50 foot buffer zone. See plan for construction notes.

7a. Project Type Checklist:

- |   |   |
|---|---|
| 1. <input checked="" type="checkbox"/> Single Family Home     | 2. <input type="checkbox"/> Residential Subdivision                   |
| 3. <input type="checkbox"/> Limited Project Driveway Crossing | 4. <input type="checkbox"/> Commercial/Industrial                     |
| 5. <input type="checkbox"/> Dock/Pier                         | 6. <input type="checkbox"/> Utilities                                 |
| 7. <input type="checkbox"/> Coastal Engineering Structure     | 8. <input type="checkbox"/> Agriculture (e.g., cranberries, forestry) |
| 9. <input type="checkbox"/> Transportation                    | 10. <input type="checkbox"/> Other                                    |

7b. Is any portion of the proposed activity eligible to be treated as a limited project subject to 310 CMR 10.24 (coastal) or 310 CMR 10.53 (inland)?

1.  Yes  No If yes, describe which limited project applies to this project:

2. Limited Project

8. Property recorded at the Registry of Deeds for:

Middlesex

a. County

77110

c. Book

b. Certificate # (if registered land)

163

d. Page Number

**B. Buffer Zone & Resource Area Impacts (temporary & permanent)**

1.  Buffer Zone Only – Check if the project is located only in the Buffer Zone of a Bordering Vegetated Wetland, Inland Bank, or Coastal Resource Area.
2.  Inland Resource Areas (see 310 CMR 10.54-10.58; if not applicable, go to Section B.3, Coastal Resource Areas).

Check all that apply below. Attach narrative and any supporting documentation describing how the project will meet all performance standards for each of the resource areas altered, including standards requiring consideration of alternative project design or location.

For all projects affecting other Resource Areas, please attach a narrative explaining how the resource area was delineated.

<u>Resource Area</u>	<u>Size of Proposed Alteration</u>	<u>Proposed Replacement (if any)</u>
a. <input type="checkbox"/> Bank	1. linear feet	2. linear feet
b. <input type="checkbox"/> Bordering Vegetated Wetland	1. square feet	2. square feet
c. <input type="checkbox"/> Land Under Waterbodies and Waterways	1. linear feet	2. linear feet
	3. cubic yards dredged	



**Massachusetts Department of Environmental Protection**  
**Bureau of Resource Protection - Wetlands**  
**WPA Form 3 – Notice of Intent**  
 Massachusetts Wetlands Protection Act M.G.L. c. 131, §40

Provided by MassDEP:

---

MassDEP File Number

---

Document Transaction Number

---

Ashland

---

City/Town

**B. Buffer Zone & Resource Area Impacts (temporary & permanent) (cont'd)**

<u>Resource Area</u>	<u>Size of Proposed Alteration</u>	<u>Proposed Replacement (if any)</u>
d. <input type="checkbox"/> <b>Bordering Land Subject to Flooding</b>	1. square feet _____ 3. cubic feet of flood storage lost _____	2. square feet _____ 4. cubic feet replaced _____
e. <input type="checkbox"/> <b>Isolated Land Subject to Flooding</b>	1. square feet _____ 2. cubic feet of flood storage lost _____	3. cubic feet replaced _____
f. <input type="checkbox"/> <b>Riverfront Area</b>	1. Name of Waterway (if available) _____	
2. Width of Riverfront Area (check one):		
<input type="checkbox"/> 25 ft. - Designated Densely Developed Areas only		
<input type="checkbox"/> 100 ft. - New agricultural projects only		
<input type="checkbox"/> 200 ft. - All other projects		
3. Total area of Riverfront Area on the site of the proposed project:		_____ square feet
4. Proposed alteration of the Riverfront Area:		
a. total square feet _____	b. square feet within 100 ft. _____	c. square feet between 100 ft. and 200 ft. _____
5. Has an alternatives analysis been done and is it attached to this NOI?		<input type="checkbox"/> Yes <input checked="" type="checkbox"/> No
6. Was the lot where the activity is proposed created prior to August 1, 1996?		<input checked="" type="checkbox"/> Yes <input type="checkbox"/> No

3.  **Coastal Resource Areas: (See 310 CMR 10.25-10.35)**

Check all that apply below. Attach narrative and supporting documentation describing how the project will meet all performance standards for each of the resource areas altered, including standards requiring consideration of alternative project design or location.

Online Users:  
 Include your document transaction number (provided on your receipt page) with all supplementary information you submit to the Department.

<u>Resource Area</u>	<u>Size of Proposed Alteration</u>	<u>Proposed Replacement (if any)</u>
a. <input type="checkbox"/> <b>Designated Port Areas</b>	Indicate size under Land Under the Ocean, below	
b. <input type="checkbox"/> <b>Land Under the Ocean</b>	1. square feet _____ 2. cubic yards dredged _____	
c. <input type="checkbox"/> <b>Barrier Beach</b>	Indicate size under Coastal Beaches and/or Coastal Dunes below	
d. <input type="checkbox"/> <b>Coastal Beaches</b>	1. square feet _____	2. cubic yards beach nourishment _____
e. <input type="checkbox"/> <b>Coastal Dunes</b>	1. square feet _____	2. cubic yards dune nourishment _____



# WPA Form 3 – Notice of Intent

Massachusetts Wetlands Protection Act M.G.L. c. 131, §40

Provided by MassDEP:

MassDEP File Number

Document Transaction Number

Ashland

City/Town

## B. Buffer Zone & Resource Area Impacts (temporary & permanent) (cont'd)

	Size of Proposed Alteration	Proposed Replacement (if any)
f. <input type="checkbox"/> Coastal Banks	1. linear feet	
g. <input type="checkbox"/> Rocky Intertidal Shores	1. square feet	
h. <input type="checkbox"/> Salt Marshes	1. square feet	2. sq ft restoration, rehab., creation
i. <input type="checkbox"/> Land Under Salt Ponds	1. square feet	
	2. cubic yards dredged	
j. <input type="checkbox"/> Land Containing Shellfish	1. square feet	
k. <input type="checkbox"/> Fish Runs	Indicate size under Coastal Banks, inland Bank, Land Under the Ocean, and/or inland Land Under Waterbodies and Waterways, above	
	1. cubic yards dredged	
l. <input type="checkbox"/> Land Subject to Coastal Storm Flowage	1. square feet	

4.  Restoration/Enhancement  
 If the project is for the purpose of restoring or enhancing a wetland resource area in addition to the square footage that has been entered in Section B.2.b or B.3.h above, please enter the additional amount here.

a. square feet of BVW \_\_\_\_\_ b. square feet of Salt Marsh \_\_\_\_\_

## C. Other Applicable Standards and Requirements

### Streamlined Massachusetts Endangered Species Act/Wetlands Protection Act Review

1. Is any portion of the proposed project located in **Estimated Habitat of Rare Wildlife** as indicated on the most recent Estimated Habitat Map of State-Listed Rare Wetland Wildlife published by the Natural Heritage and Endangered Species Program (NHESP)? To view habitat maps, see the *Massachusetts Natural Heritage Atlas* or go to <http://www.mass.gov/dfwele/dfw/nhosp/nhregmap.htm>.

a.  Yes  No **If yes, include proof of mailing or hand delivery of NOI to:**

Natural Heritage and Endangered Species Program  
 Division of Fisheries and Wildlife  
 Route 135, North Drive  
 Westborough, MA 01581

2017 \_\_\_\_\_  
 b. Date of map

If yes, the project is also subject to Massachusetts Endangered Species Act (MESA) review (321 CMR 10.18). To qualify for a streamlined, 30-day, MESA/Wetlands Protection Act review, please complete Section C.1.C, and include requested materials with this Notice of Intent (NOI); OR complete Section C.1.d, if applicable. If MESA supplemental information is not included with the NOI, by completing Section 1 of this form, the NHESP will require a separate MESA filing which may take up to 90 days to review (unless noted exceptions in Section 2 apply, see below).



# WPA Form 3 – Notice of Intent

Massachusetts Wetlands Protection Act M.G.L. c. 131, §40

Provided by MassDEP:

MassDEP File Number

Document Transaction Number

Ashland

City/Town

## C. Other Applicable Standards and Requirements (cont'd)

### 1. c. Submit Supplemental Information for Endangered Species Review \*

1.  Percentage/acreage of property to be altered:

(a) within wetland Resource Area

percentage/acreage

(b) outside Resource Area

percentage/acreage

2.  Assessor's Map or right-of-way plan of site

3.  Project plans for entire project site, including wetland resource areas and areas outside of wetlands jurisdiction, showing existing and proposed conditions, existing and proposed tree/vegetation clearing line, and clearly demarcated limits of work \*\*

(a)  Project description (including description of impacts outside of wetland resource area & buffer zone)

(b)  Photographs representative of the site

(c)  MESA filing fee (fee information available at:

<http://www.mass.gov/dfwele/dfw/nhosp/nhenvmesa.htm>)

Make check payable to "Natural Heritage & Endangered Species Fund" and *mail to NHESP* at above address

*Projects altering 10 or more acres of land, also submit:*

(d)  Vegetation cover type map of site

(e)  Project plans showing Priority & Estimated Habitat boundaries

### d. OR Check One of the Following

1.  Project is exempt from MESA review.

Attach applicant letter indicating which MESA exemption applies. (See 321 CMR 10.14, <http://www.mass.gov/dfwele/dfw/nhosp/nhenvexemptions.htm>; the NOI must still be sent to NHESP if the project is within estimated habitat pursuant to 310 CMR 10.37 and 10.59.)

2.  Separate MESA review ongoing.

a. NHESP Tracking Number

b. Date submitted to NHESP

3.  Separate MESA review completed.

Include copy of NHESP "no Take" determination or valid Conservation & Management Permit with approved plan.

\* Some projects not in Estimated Habitat may be located in Priority Habitat, and require NHESP review (see [www.nhosp.org](http://www.nhosp.org) regulatory review tab). Priority Habitat includes habitat for state-listed plants and strictly upland species not protected by the Wetlands Protection Act.

\*\* MESA projects may not be segmented (321 CMR 10.16). The applicant must disclose full development plans even if such plans are not required as part of the Notice of Intent process.



# WPA Form 3 – Notice of Intent

Massachusetts Wetlands Protection Act M.G.L. c. 131, §40

Provided by MassDEP:

MassDEP File Number

Document Transaction Number

Ashland

City/Town

## C. Other Applicable Standards and Requirements (cont'd)

2. For coastal projects only, is any portion of the proposed project located below the mean high water line or in a fish run?

a.  Not applicable – project is in inland resource area only

b.  Yes  No If yes, include proof of mailing or hand delivery of NOI to either:

South Shore - Cohasset to Rhode Island, and the Cape & Islands:

North Shore - Hull to New Hampshire:

Division of Marine Fisheries - Southeast Marine Fisheries Station  
Attn: Environmental Reviewer  
838 South Rodney French Blvd.  
New Bedford, MA 02744

Division of Marine Fisheries - North Shore Office  
Attn: Environmental Reviewer  
30 Emerson Avenue  
Gloucester, MA 01930

Also if yes, the project may require a Chapter 91 license. For coastal towns in the Northeast Region, please contact MassDEP's Boston Office. For coastal towns in the Southeast Region, please contact MassDEP's Southeast Regional Office.

3. Is any portion of the proposed project within an Area of Critical Environmental Concern (ACEC)?

a.  Yes  No If yes, provide name of ACEC (see instructions to WPA Form 3 or MassDEP Website for ACEC locations). **Note:** electronic filers click on Website.

see attach March 2007 list

b. ACEC

4. Is any portion of the proposed project within an area designated as an Outstanding Resource Water (ORW) as designated in the Massachusetts Surface Water Quality Standards, 314 CMR 4.00?

a.  Yes  No

5. Is any portion of the site subject to a Wetlands Restriction Order under the Inland Wetlands Restriction Act (M.G.L. c. 131, § 40A) or the Coastal Wetlands Restriction Act (M.G.L. c. 130, § 105)?

a.  Yes  No

6. Is this project subject to provisions of the MassDEP Stormwater Management Standards?

a.  Yes. Attach a copy of the Stormwater Report as required by the Stormwater Management Standards per 310 CMR 10.05(6)(k)-(q) and check if:

1.  Applying for Low Impact Development (LID) site design credits (as described in Stormwater Management Handbook Vol. 2, Chapter 3)

2.  A portion of the site constitutes redevelopment

3.  Proprietary BMPs are included in the Stormwater Management System.

b.  No. Check why the project is exempt:

1.  Single-family house

2.  Emergency road repair

3.  Small Residential Subdivision (less than or equal to 4 single-family houses or less than or equal to 4 units in multi-family housing project) with no discharge to Critical Areas.

Online Users:  
Include your document transaction number (provided on your receipt page) with all supplementary information you submit to the Department.



Massachusetts Department of Environmental Protection  
Bureau of Resource Protection – Wetlands & Waterways

**BRP WPA Form 3 - Notice of Intent**  
**Instructions and Supporting Materials**

**TOWNS WITH ACECs WITHIN THEIR BOUNDARIES**

Town	ACEC NAME	Town	ACEC NAME
Ashby	Squannassit	Lunenburg	Squannassit
Ayer	Petapawag and Squannassit	Lynn	Rumney Marshes
Barnstable	Sandy Neck/Barnstable Harbor	Mansfield	Canoe River Aquifer
Bolton	Central Nashua River Valley	Mashpee	Waquoit Bay
Boston	Rumney Marshes	Melrose	Golden Hills
	Fowl Meadow and Ponkapoag Bog	Milton	Fowl Meadow and Ponkapoag Bog
	Neponset River Estuary		Neponset River Estuary
Bourne	Pocasset River	Mt Washington	Karner Brook Watershed, Schenob Brook
	Herring River Watershed		Parker River/Essex Bay
	Bourne Back River	Newbury	Hockomock Swamp
Braintree	Cranberry Brook Watershed	Norton	Canoe River Aquifer
Brewster	Pleasant Bay, Inner Cape Cod Bay		Three Mile River
Bridgewater	Hockomock Swamp		Fowl Meadow and Ponkapoag Bog
Canton	Fowl Meadow and Ponkapoag Bog	Norwood	Inner Cape Cod Bay, Pleasant Bay
Chatham	Pleasant Bay	Orleans	Petapawag and Squannassit
Cohasset	Weir River	Pepperell	Hinsdale Flats Watershed
Dalton	Hinsdale Flats Watershed	Peru	Herring River Watershed, Ellisville Harbor
Dedham	Fowl Meadow and Ponkapoag Bog	Plymouth	Neponset River Estuary
Dighton	Three Mile River		Fowl Meadow and Ponkapoag Bog
Dunstable	Petapawag	Quincy	Hockomock Swamp
Eastham	Inner Cape Cod Bay	Randolph	Rumney Marshes
	Wellfleet Harbor	Raynham	Parker River/Essex Bay
Easton	Canoe River Aquifer	Revere	Sandy Neck/Barnstable Harbor
	Hockomock Swamp	Rowley	Rumney Marshes, Golden Hills
Egremont	Karner Brook Watershed	Sandwich	Canoe River Aquifer
Essex	Parker River/Essex Bay	Saugus	Fowl Meadow and Ponkapoag Bog
Falmouth	Waquoit Bay	Sharon	Schenob Brook
Foxborough	Canoe River Aquifer		Squannassit
Gloucester	Parker River/Essex Bay	Sheffield	Kampoosa Bog Drainage Basin
Groton	Petapawag and Squannassit	Shirley	Hockomock Swamp, Canoe River Aquifer, Three Mile River
Grafton	Miscoe-Warren-Whitehall Watersheds	Stockbridge	Squannassit
Harvard	Central Nashua River Valley	Taunton	Squannassit
	Squannassit		Wellfleet Harbor
Harwich	Pleasant Bay	Townsend	Petapawag
Hingham	Weir River, Weymouth Back River	Truro	Miscoe-Warren-Whitehall Watersheds
Hinsdale	Hinsdale Flats Watershed	Tyngsborough	Golden Hills
Holbrook	Cranberry Brook Watershed	Upton	Hinsdale Flats Watershed
Hopkinton	Westborough Cedar Swamp	Wakefield	Wellfleet Harbor
	Miscoe-Warren-Whitehall Watersheds	Washington	Hockomock Swamp
Hull	Weir River	Wellfleet	Westborough Cedar Swamp
Ipswich	Parker River/Essex Bay	W Bridgewater	Fowl Meadow and Ponkapoag Bog
Lancaster	Central Nashua River Valley	Westborough	Weymouth Back River
	Squannassit	Westwood	Rumney Marshes
Lee	Kampoosa Bog Drainage Basin	Weymouth	
Leominster	Central Nashua River Valley	Winthrop	



**Massachusetts Department of Environmental Protection**  
**Bureau of Resource Protection - Wetlands**  
**WPA Form 3 – Notice of Intent**  
 Massachusetts Wetlands Protection Act M.G.L. c. 131, §40

Provided by MassDEP:

MassDEP File Number \_\_\_\_\_

Document Transaction Number \_\_\_\_\_

Ashland \_\_\_\_\_

City/Town \_\_\_\_\_

**D. Additional Information**

Applicants must include the following with this Notice of Intent (NOI). See instructions for details.

**Online Users:** Attach the document transaction number (provided on your receipt page) for any of the following information you submit to the Department.

1.  USGS or other map of the area (along with a narrative description, if necessary) containing sufficient information for the Conservation Commission and the Department to locate the site. (Electronic filers may omit this item.)
2.  Plans identifying the location of proposed activities (including activities proposed to serve as a Bordering Vegetated Wetland [BVW] replication area or other mitigating measure) relative to the boundaries of each affected resource area.
3.  Identify the method for BVW and other resource area boundary delineations (MassDEP BVW Field Data Form(s), Determination of Applicability, Order of Resource Area Delineation, etc.), and attach documentation of the methodology.
4.  List the titles and dates for all plans and other materials submitted with this NOI.

**SITE LAYOUT AND SYSTEM DESIGN**

a. Plan Title	_____
Robial	Jay Thrasher
b. Prepared By	c. Signed and Stamped by
April 6, 2023	1"=20'
d. Final Revision Date	e. Scale

f. Additional Plan or Document Title	_____	g. Date	_____
--------------------------------------	-------	---------	-------

5.  If there is more than one property owner, please attach a list of these property owners not listed on this form.
6.  Attach proof of mailing for Natural Heritage and Endangered Species Program, if needed.
7.  Attach proof of mailing for Massachusetts Division of Marine Fisheries, if needed.
8.  Attach NOI Wetland Fee Transmittal Form
9.  Attach Stormwater Report, if needed.

**E. Fees**

1.  Fee Exempt: No filing fee shall be assessed for projects of any city, town, county, or district of the Commonwealth, federally recognized Indian tribe housing authority, municipal housing authority, or the Massachusetts Bay Transportation Authority.

Applicants must submit the following information (in addition to pages 1 and 2 of the NOI Wetland Fee Transmittal Form) to confirm fee payment:

1625	4/20/23
2. Municipal Check Number	3. Check date
1627	4/20/23
4. State Check Number	5. Check date
Karon	Skinner Catrone
6. Payor name on check: First Name	7. Payor name on check: Last Name

KARON SKINNER CATRONE  
63 GILBERT DR  
STOUGHTON MA 02072-3913

1625  
53-13/110 MA  
1865

4/20/23  
DATE

PAY TO THE ORDER OF Town of Ashland \$ 67<sup>50</sup>  
sixty seven <sup>50</sup>/<sub>100</sub> DOLLARS 

BANK OF AMERICA 

Wealth Management Banking

ACH R/T 011000138

34 High St Lot 2

Karon Skinner  EP

KARON SKINNER CATRONE  
63 GILBERT DR  
STOUGHTON MA 02072-3913

1627  
53-13/110 MA  
1865

4/20/23  
DATE

PAY TO THE ORDER OF Commonwealth of MA \$ 42<sup>50</sup>  
forty two <sup>50</sup>/<sub>100</sub> DOLLARS 

BANK OF AMERICA 

Wealth Management Banking

ACH R/T 011000138

34 High St. Lot 2

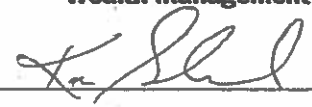
Karon Skinner  EP

KARON SKINNER CATRONE  
63 GILBERT DR  
STOUGHTON MA 02072-3913

1658  
53-13/110 MA  
1865

4/20/23  
DATE

PAY TO THE ORDER OF Town of Ashland \$ 110<sup>00</sup>  
One hundred ten <sup>00</sup>/<sub>100</sub> DOLLARS 

BANK OF AMERICA 

Wealth Management Banking

ACH R/T 011000138

34 High St. Lot 2

Karon Skinner  EP



# WPA Form 3 – Notice of Intent

Massachusetts Wetlands Protection Act M.G.L. c. 131, §40

Provided by MassDEP:

MassDEP File Number

Document Transaction Number



Ashland

City/Town

## F. Signatures and Submittal Requirements

I hereby certify under the penalties of perjury that the foregoing Notice of Intent and accompanying plans, documents, and supporting data are true and complete to the best of my knowledge. I understand that the Conservation Commission will place notification of this Notice in a local newspaper at the expense of the applicant in accordance with the wetlands regulations, 310 CMR 10.05(5)(a).

I further certify under penalties of perjury that all abutters were notified of this application, pursuant to the requirements of M.G.L. c. 131, § 40. Notice must be made by Certificate of Mailing or in writing by hand delivery or certified mail (return receipt requested) to all abutters within 100 feet of the property line of the project location.

	<u>4/20/23</u>
1. Signature of Applicant	2. Date
	<u>4/20/23</u>
3. Signature of Property Owner (if different)	4. Date
	<u>4/20/23</u>
5. Signature of Representative (if any)	6. Date

### For Conservation Commission:

Two copies of the completed Notice of Intent (Form 3), including supporting plans and documents, two copies of the NOI Wetland Fee Transmittal Form, and the city/town fee payment, to the Conservation Commission by certified mail or hand delivery.

### For MassDEP:

One copy of the completed Notice of Intent (Form 3), including supporting plans and documents, one copy of the NOI Wetland Fee Transmittal Form, and a copy of the state fee payment to the MassDEP Regional Office (see Instructions) by certified mail or hand delivery.

### Other:

If the applicant has checked the "yes" box in any part of Section C, Item 3, above, refer to that section and the Instructions for additional submittal requirements.

The original and copies must be sent simultaneously. Failure by the applicant to send copies in a timely manner may result in dismissal of the Notice of Intent.



**Massachusetts Department of Environmental Protection**  
**Bureau of Resource Protection - Wetlands**  
**NOI Wetland Fee Transmittal Form**  
 Massachusetts Wetlands Protection Act M.G.L. c. 131, §40

**Important:** When filling out forms on the computer, use only the tab key to move your cursor - do not use the return key.



**A. Applicant Information**

**1. Applicant:**

Matt  
 a. First Name \_\_\_\_\_ b. Last Name \_\_\_\_\_  
 c. Organization \_\_\_\_\_  
 280 Moody St.  
 d. Mailing Address \_\_\_\_\_  
 Waltham MA 02453  
 e. City/Town \_\_\_\_\_ f. State \_\_\_\_\_ g. Zip Code \_\_\_\_\_  
 508-304-5409  
 h. Phone Number \_\_\_\_\_ i. Fax Number \_\_\_\_\_ j. Email Address \_\_\_\_\_

**2. Property Owner (if different):**

Daniel and Meredith Huff  
 a. First Name \_\_\_\_\_ b. Last Name \_\_\_\_\_  
 c. Organization \_\_\_\_\_  
 34 High Street  
 d. Mailing Address \_\_\_\_\_  
 Ashland MA 01721  
 e. City/Town \_\_\_\_\_ f. State \_\_\_\_\_ g. Zip Code \_\_\_\_\_  
 h. Phone Number \_\_\_\_\_ i. Fax Number \_\_\_\_\_ j. Email Address \_\_\_\_\_

**3. Project Location:**

34 High Street, lot 2 Ashland  
 a. Street Address \_\_\_\_\_ b. City/Town \_\_\_\_\_

**B. Fees**

The fee should be calculated using the following six-step process and worksheet. **Please see Instructions before filling out worksheet.**

**Step 1/Type of Activity:** Describe each type of activity that will occur in wetland resource area and buffer zone.

**Step 2/Number of Activities:** Identify the number of each type of activity.

**Step 3/Individual Activity Fee:** Identify each activity fee from the six project categories listed in the instructions.

**Step 4/Subtotal Activity Fee:** Multiply the number of activities (identified in Step 2) times the fee per category (identified in Step 3) to reach a subtotal fee amount. Note: If any of these activities are in a Riverfront Area in addition to another Resource Area or the Buffer Zone, the fee per activity should be multiplied by 1.5 and then added to the subtotal amount.

**Step 5/Total Project Fee:** Determine the total project fee by adding the subtotal amounts from Step 4.

**Step 6/Fee Payments:** To calculate the state share of the fee, divide the total fee in half and subtract \$12.50. To calculate the city/town share of the fee, divide the total fee in half and add \$12.50.

To calculate filing fees, refer to the category fee list and examples in the instructions for filling out WPA Form 3 (Notice of Intent).



**Massachusetts Department of Environmental Protection**  
 Bureau of Resource Protection - Wetlands  
**NOI Wetland Fee Transmittal Form**  
 Massachusetts Wetlands Protection Act M.G.L. c. 131, §40

**B. Fees (continued)**

Step 1/Type of Activity	Step 2/Number of Activities	Step 3/Individual Activity Fee	Step 4/Subtotal Activity Fee
1a - work on a single family lot	1	\$110.00	\$110.00

**Step 5/Total Project Fee:** \$110.00

**Step 6/Fee Payments:**

Total Project Fee: \$110.00  
 a. Total Fee from Step 5

State share of filing Fee: \$42.50  
 b. 1/2 Total Fee less \$12.50

City/Town share of filling Fee: \$67.50  
 c. 1/2 Total Fee plus \$12.50

**C. Submittal Requirements**

- a.) Complete pages 1 and 2 and send with a check or money order for the state share of the fee, payable to the Commonwealth of Massachusetts.

Department of Environmental Protection  
 Box 4062  
 Boston, MA 02211

- b.) **To the Conservation Commission:** Send the Notice of Intent or Abbreviated Notice of Intent; a copy of this form; and the city/town fee payment.

**To MassDEP Regional Office (see Instructions):** Send a copy of the Notice of Intent or Abbreviated Notice of Intent; a copy of this form; and a copy of the state fee payment. (E-filers of Notices of Intent may submit these electronically.)

## Notification to Abutters

### By Hand Delivery, Certified Mail (return receipt requested), or Certificates of Mailing

*This is a notification required by law. You are receiving this notification because you have been identified as the owner of land abutting another parcel of land for which certain activities are proposed. Those activities require a permit under the Massachusetts Wetlands Protection Act (M.G.L. c. 131, § 40).*

In accordance with the second paragraph of the Massachusetts Wetlands Protection Act, 310 CMR 10.05(4)(a) of the Wetlands Regulations, and the Ashland General Wetlands Protection Bylaw, you are hereby notified that:

- A. A Notice of Intent was filed with the Ashland Conservation Commission on January 6, 2023 seeking permission to remove, fill, dredge, or alter an area subject to protection under M.G.L. c. 131 §40. The following is a description of the proposed activity/activities:

Installation of a bio retention area and a portion of an in-ground pool within the 100 foot buffer zone.

- B. The name of the applicant is: Daniel and Meredith Huff.
- C. The address of the land where the activity is proposed is: 34 High Street, Ashland, MA 01721.
- D. Copies of the Notice of Intent may be examined or obtained at the office of the Ashland Conservation Commission, located at 101 Main Street, Ashland, MA. The regular business hours of the Commission are Monday, Tuesday, Thursday 8:00 am – 3:30 pm and Wednesday 8:00 am – 7:00 pm., and the Commission may be reached at 508-881-0100.
- E. Copies of the Notice of Intent may be obtained from the applicant or Karon Skinner Catrone, representative, by calling 508-668-4401. An administrative fee may be applied for providing copies of the NOI and plans.
- F. Information regarding the date, time, and location of the public hearing regarding the Notice of Intent may be obtained from the Ashland Conservation Commission. Notice of the public hearing will be published at least five business days in advance, in the Metrowest Daily News.

Notification provided pursuant to the above requirement does not automatically confer standing to the recipient to request Departmental Action for the underlying matter. See 310 CMR 10.05(7)(a)4.

**AFFIDAVIT OF SERVICE**

**Under the Massachusetts Wetlands Protection Act  
and the Ashland Wetland Protection Bylaw**

I, Karon Skinner Catrone hereby certify under the pains and penalties of perjury that on or about April 24, 2023 I will give notification to abutters in compliance with the second paragraph of Massachusetts General Laws Chapter 131, Section 40 in connection with the following matter:

A Notice of Intent filed under the Massachusetts  
Wetland Protection Act and the Ashland Wetland Protection Bylaw for

Daniel and Meredith Huff with the

Ashland Conservation Commission on April 20, 2023 for

Property located at 34 High Street, Ashland, MA.

The form of the notification, and a list of the abutters to whom it was given and their addresses are attached to this Affidavit of Service.

Karon Skinner Catrone  
Name

4/20/23  
Date

# DEP Bordering Vegetated Wetland (310 CMR 10.55) Delineation Field Data Form

Applicant: \_\_\_\_\_ Prepared by: Karon Skinner Catrone Project Location: 34 High Street DEP File #: \_\_\_\_\_

Check all that apply:

- Vegetation alone presumed adequate to delineate BVW boundary: fill out Section I only
- Vegetation and other indicators of hydrology used to delineate BVW boundary: fill out Sections I and II
- Method other than dominance test used (attach additional information)

**Section I. Vegetation** Observation Plot Number: \_\_\_\_\_ Upland Transect Number: **Flag 4** Date of Delineation: **4/10/2021**

A. Sample Layer and Plant Species (by common/scientific name)	B. Percent Cover (or basal area)	C. Percent Dominance	D. Dominant Plant (yes or no)	E. Wetland Indicator Category*
Ground cover				
Grass/Echinochloa crusgalli	20.5/20.5	100	YES	FACU
<u>Shrub</u>				
Forsythia/Forsythia intermedia	20.5/20.5	100	YES	FACU

- Use an asterisk to mark indicator plants: plant species listed in the wetlands Protection Act (MGL c.131, s.40); plants in the genus *Sphagnum*; plants listed as FAC, FAC+, FACW, FACW-, FACW, FACW+, or OBL; or plants with physiological or morphological adaptations. If any plants are identified as wetland indicator plants due to physiological or morphological adaptations, describe the adaptation next to the asterisk.

**Vegetation conclusion:**  
 Number of dominant wetland indicator plants: 0      Number of dominant non-wetland indicator plants: 2  
 Is the number of dominant wetland plants equal to or greater than the number of dominant non-wetland plants:    yes     no

Section II. Indicators of Hydrology

Other Indicators of Hydrology: (check all that apply and describe)

Hydric Soil Interpretation

1. Soil Survey

Is there a published soil survey for this site?      yes      no

title/date

map number:

soil type mapped: Rainbox 90% Broadbrook 5% Paxton 3%

hydric soil inclusions:

Are field observations consistent with soil survey?      yes      no

Remarks: Sunny day

2. Soil Description

Horizon	Depth	Matrix Color	Mottles Color
Leaf litter	0"-1"		
A	1"-8"	10 yr 3/3	
B	8"-	10 yr 5/6	

Remarks: Sunny

3. Other:

Conclusion: Is soil hydric?      yes      no     

- Site inundated: \_\_\_\_\_
- Depth to free water in observation hole: \_\_\_\_\_
- Depth to soil saturation in observation hole: \_\_\_\_\_
- Water marks: \_\_\_\_\_
- Drift lines: \_\_\_\_\_
- Sediment deposits: \_\_\_\_\_
- Drainage patterns in BVW: \_\_\_\_\_
- Oxidized rhizospheres: \_\_\_\_\_
- Water-stained leaves: \_\_\_\_\_
- Recorded data (stream, lake, or tidal gauge; aerial photo; other): \_\_\_\_\_
- Other: \_\_\_\_\_

Vegetation and Hydrology Conclusion

	yes	no
Number of wetland indicator plants greater than or equal to number of non-wetland indicator plants	<input type="checkbox"/>	<input checked="" type="checkbox"/>
Wetland hydrology present: hydric soil present	<input type="checkbox"/>	<input checked="" type="checkbox"/>
other indicators of hydrology present		<input checked="" type="checkbox"/>

Sample location is in BVW

# DEP Bordering Vegetated Wetland (310 CMR 10.55) Delineation Field Data Form

Applicant: \_\_\_\_\_ Prepared by: Karon Skinner Catrone Project Location: 34 High Street DEP File #: \_\_\_\_\_

Check all that apply:

- Vegetation alone presumed adequate to delineate BVW boundary: fill out Section I only
- Vegetation and other indicators of hydrology used to delineate BVW boundary: fill out Sections I and II
- Method other than dominance test used (attach additional information)

**Section I. Vegetation**    Observation Plot Number: **Wetland**    Transect Number: **Flag 4**    Date of Delineation: **4/10/21**

**A. Sample Layer and Plant Species**    **B. Percent Cover**    **C. Percent Dominance**    **D. Dominant Plant**    **E. Wetland Indicator**  
 (by common/scientific name)    (or basal area)    (yes or no)    Category\*

Ground Cover:

Sphagnum Moss	10.5/31.5	33.3	YES	*FACW
Skunk cabbage/Symplocarpus foetidus	10.5/31.5	33.3	YES	*OBL
Raspberry/Rubus idaeus	10.5/31.5	33.3	NO	*IN

Shrub

Raspberry/Rubus idaeus	20.5/31	69.3	YES	IN
Forsythia/Forsythia intermedia	10.5/31	33.8	NO	FACU

- Use an asterisk to mark indicator plants: plant species listed in the wetlands Protection Act (MGL c.131, s.40); plants in the genus *Sphagnum*; plants listed as FAC, FAC+, FACW-, FACW, FACW+, or OBL; or plants with physiological or morphological adaptations. If any plants are identified as wetland indicator plants due to physiological or morphological adaptations, describe the adaptation next to the asterisk.

**Vegetation conclusion:**

Number of dominant wetland indicator plants: **2**

Number of dominant non-wetland indicator plants: **0**

Is the number of dominant wetland plants equal to or greater than the number of dominant non-wetland plants:    yes     no

*If vegetation alone is presumed adequate to delineate the BVW boundary, submit this form with the Request for Determination of Applicability or Notice of Intent.*

**Wetland soils**

**Exhibit**

**Section II. Indicators of Hydrology**

Other Indicators of Hydrology: (check all that apply and describe)

**Hydric Soil Interpretation**

1. Soil Survey -

Is there a published soil survey for this site?  Yes  no

title/date:

map number:

soil type mapped: Rainbox 90% Broadbrook 5% Paxton 3%

hydric soil inclusions:

Are field observations consistent with soil survey?  yes  no

Remarks: Sunny day

2. Soil Description

Horizon	Depth	Matrix Color	Mottles Color
Leaf litter	0-1"		
Oe	1"-3"	10 yr 3/1	
O	3"-	10 yr 3/1	

Remarks :

3. Other:

Conclusion: Is soil hydric?  yes  no

**Vegetation and Hydrology Conclusion**

Number of wetland indicator plants greater than or equal to number of non-wetland indicator plants  yes  no

Wetland hydrology present:

hydric soil present

other indicators of hydrology present

**Sample location is in BVW**

## Project Summary

This Stormwater and Erosion Control Report discusses the stormwater management system for the residential pool and tennis court development at 34 High in Ashland, Massachusetts. The property (Map #13, Block #163) is currently owned by Meredith & Daniel Huff.



Figure 1.1 - Locus map of the 34 High Street Lot#2 residential project site.

## Existing Conditions

The existing site is a recent subdivision of approximately 48,084 SF (1.1 acres) with a 10,598 SF access easement. Existing impervious area on the residential site includes a 2,823 SF pool and apron.

In general, the existing topography on the site runs downhill from the southern corner of the property to the northern property border adjacent to High Street. The average slope of the property is roughly 10%. The existing impervious area includes an abandoned pool area with concrete area that covers about 2,823 SF, or 5.9% of the property. The remainder of the site is about 11.8% wetland and 82.4% wooded area. The easement is undeveloped and wooded. Two design points were analyzed for the run-off from the project site: The easement connection to the High Street (Design Point #1) and the wetland boundary to the west (Design Point #2).



# NHESP data

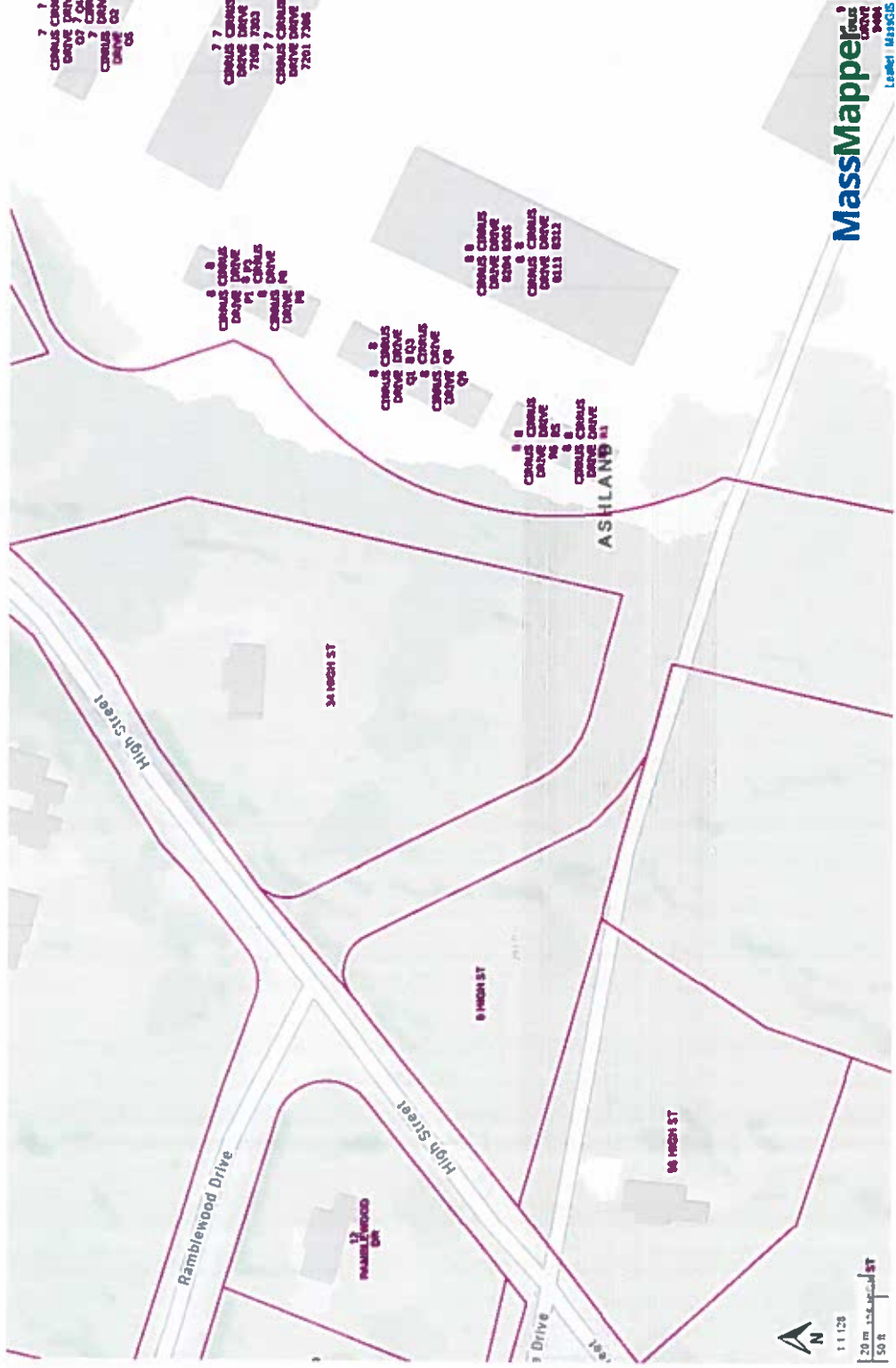

**MassMapper**  
Local MASSGIS

- Potential Vernal Pools
- NHESP Priority Habitats of Rare Species
- NHESP Natural Communities
- NHESP Estimated Habitats of Rare Wildlife
- NHESP Certified Vernal Pools
- NHESP Ecoregions
- Areas of Critical Environmental Concern ACECs Boundaries
- ROAD/RAIL BASED
- RIVER BASED
- WETLAND BASED
- FLOODPLAIN BASED
- TIDAL BASED
- CONTOUR BASED
- POLITICAL BOUNDARY
- PROPERTY LINE BASED
- OTHER
- NOT DEFINED
- Areas of Critical Environmental Concern ACECs Transparent Green
- Areas of Critical Environmental Concern ACECs
- Property Tax Parcels

# USGS data

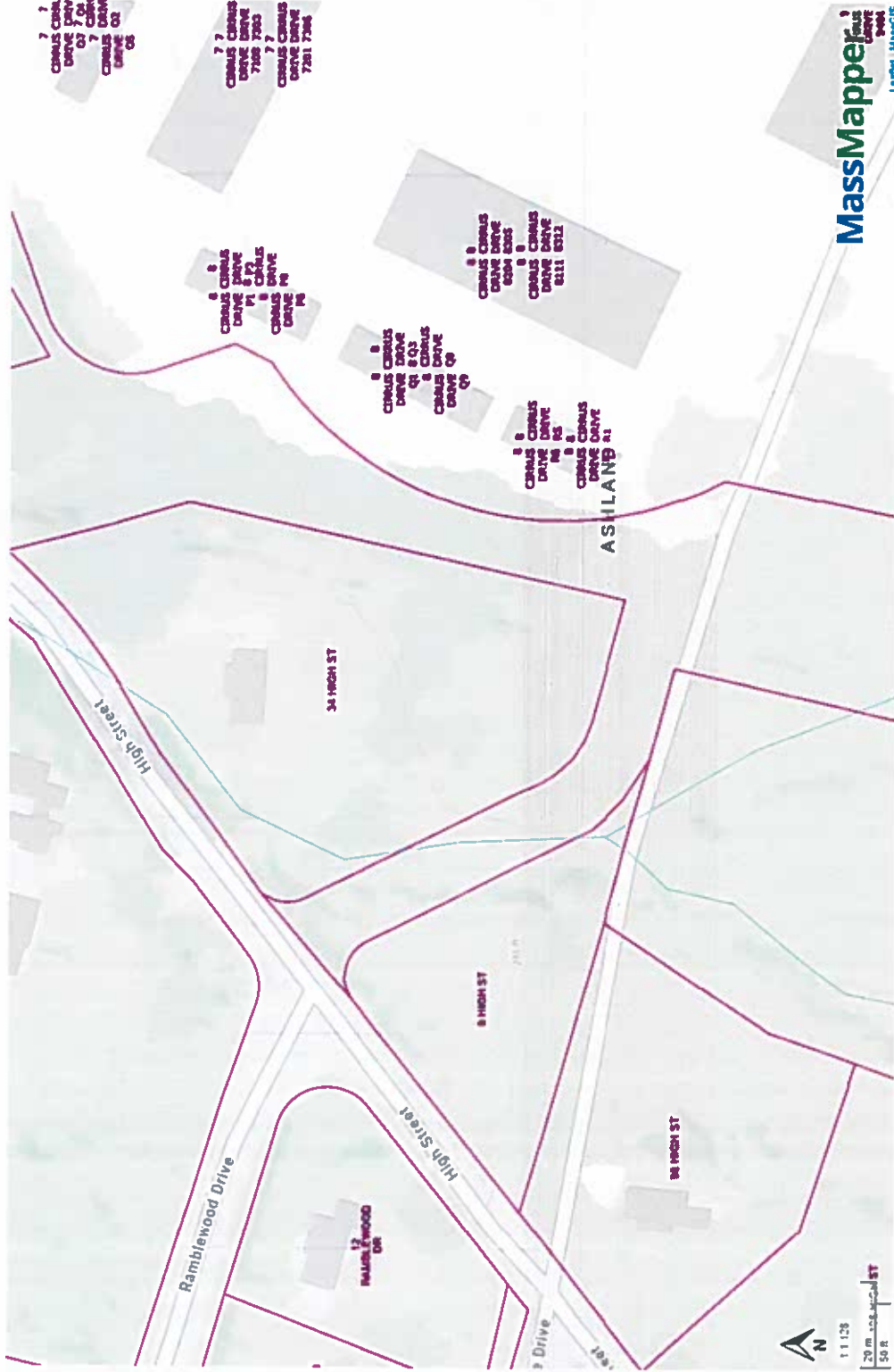

11128  
20 m  
50 ft

MassMapper  
Leibel | MassGIS

## DEP Wetlands Hydrologic Connections

### USGS Water Bodies 25k

- LAKE, POND, OCEAN
- RESERVOIR
- WETLAND
- SALT WETLAND
- SUBMERGED WETLAND
- CRANBERRY BOG
- TIDAL FLAT
- INUNDATED AREA

### USGS Rivers and Streams 25k

- Stream
- INTERMITTENT STREAM
- SHORELINE
- INTERMITTENT SHORELINE
- MANMADE SHORELINE
- DITCH/CANAL
- AQUEDUCT
- DAM
- CHANNEL IN WATER

### Major Ponds

### Major Streams

### USGS Streams 100k

### USGS Ponds 100k

### Property Tax Parcels

# National Flood Hazard Layer FIRMette



71°29'28"W 42°15'48"N

## Legend

SEE FIS REPORT FOR DETAILED LEGEND AND INDEX MAP FOR FIRM PANEL LAYOUT

<b>SPECIAL FLOOD HAZARD AREAS</b>	Without Base Flood Elevation (BFE) <i>Zone A, V, AP5</i>	With BFE or Depth <i>Zone AE, AO, AH, VE, AR</i>	Regulatory Floodway
<b>OTHER AREAS OF FLOOD HAZARD</b>	0.2% Annual Chance Flood Hazard, Area of 1% annual chances flood with average depth less than one foot or with drained areas of less than one square mile <i>Zone X</i>	Future Conditions 1% Annual Chance Flood Hazard <i>Zone X</i>	Area with Reduced Flood Risk due to Levee. See Notes. <i>Zone X</i>
<b>OTHER AREAS</b>	Area of Minimal Flood Hazard <i>Zone X</i>	Effective LOMRs	Area of Undetermined Flood Hazard <i>Zone X</i>
<b>GENERAL STRUCTURES</b>	Channel, Culvert, or Storm Sewer	Levee, Dike, or Floodwall	
<b>OTHER FEATURES</b>	Cross Sections with 1% Annual Chance Water Surface Elevation	Coastal Transect	Base Flood Elevation Line (BFE)
	Limit of Study	Jurisdiction Boundary	Coastal Transect Baseline
	Profile Baseline	Hydrographic Feature	
<b>MAP PANELS</b>	Digital Data Available	No Digital Data Available	Unmapped

The pin displayed on the map is an approximate point selected by the user and does not represent an authoritative property location.

This map complies with FEMA's standards for the use of digital flood maps. It is not void as described below. The basemap shown complies with FEMA's basemap accuracy standards. The flood hazard information is derived directly from the authoritative NFHL web services provided by FEMA. This map was exported on 4/19/2023 at 4:13 PM and does not reflect changes or amendments subsequent to this date and time. The NFHL and effective information may change or become superseded by new data over time.

This map image is void if the one or more of the following map elements do not appear: basemap imagery, flood zone labels, legend, scale bar, map creation date, community identifiers, FIRM panel number, and FIRM effective date. Map images for unmapped and unmodernized areas cannot be used for regulatory purposes.



71°29'28"W 42°15'22"N

0 250 500 1,000 1,500 2,000 Feet

1:6,000