

LOT 1
 AREA=146,100± SF
 OR
 3.35± AC.

ASSESSORS MAP 19 LOT 212
 LAND COURT BOOK 1593 PAGE 36

NOTE: ALL ELEVATIONS SHOWN REFER TO NAVD88.

NOTE: CONTRACTOR TO VERIFY ACTUAL LOCATION OF EXISTING UTILITY SERVICES IN THE FIELD PRIOR TO ANY EXCAVATION OR CONSTRUCTION. CALL DIGSAFE: 811.

NOTE: THE WETLANDS AND RIVER BANK SHOWN WERE DELINEATED BY McARTHUR ENVIRONMENTAL CONSULTING, LLC ON OCTOBER 26, 2024.

NOTE: THE WORK SHOWN ON THIS PLAN IS SUBJECT TO AN ORDER OF CONDITIONS FROM THE ASHLAND CONSERVATION COMMISSION TO WHICH THE CONTRACTOR SHOULD REFER FOR ADDITIONAL CONSTRUCTION REQUIREMENTS AND RESTRICTIONS.

THE AREA OF THE "SHED" AND STEPS IS 223 SF.

THE AREA OF THE WOOD BRIDGE IS 89 SF.

THE AREA OF THE TREE STUMP STEPS AND RET. WALL IS 22 SF.

THE AREA OF THE LOT WITHIN THE 200' RIPARIAN ZONE IS 87,611 SF.

COMMON NAME	BOTANICAL NAME	QUANTITY	SIZE
RED MAPLE	Acer rubrum	2	1" - 2" CALIPER
NORTHERN ARROWWOOD	Viburnum dentatum	4	18" - 24"
WITCH HAZEL	Hamamelis virginiana	2	18" - 24"
CINNAMON FERN	Osmunda cinnamomea	5	1 GALLON POT

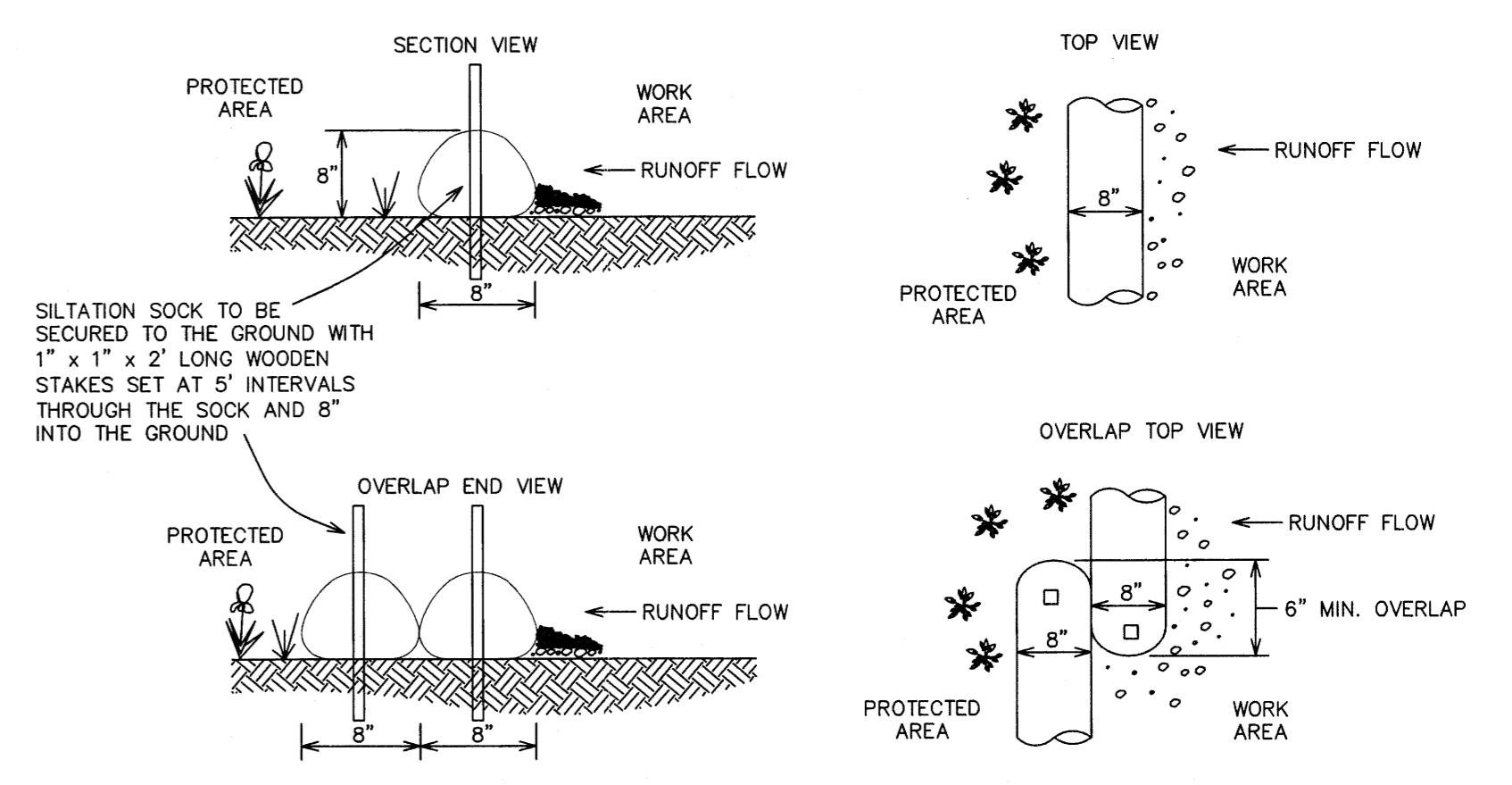

SILT SOCK DETAIL
 (NOT TO SCALE)

SILTATION CONTROL TO BE INSTALLED PRIOR TO ANY CONSTRUCTION AND TO REMAIN IN PLACE AND FUNCTIONAL UNTIL ALL DISTURBED AREAS HAVE BEEN STABILIZED AGAINST EROSION.

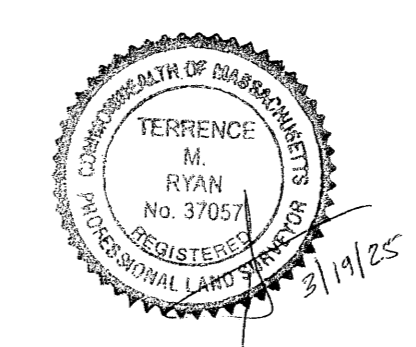

**PLAN TO ACCOMPANY NOTICE OF INTENT
 66 WEST UNION STREET
 ASHLAND, MASS.**

PREPARED FOR: SHAWN R. ARNOLD
 66 WEST UNION STREET
 ASHLAND, MASS. 01721

PROPERTY OF: SHAWN R. ARNOLD
 66 WEST UNION STREET
 ASHLAND, MASS. 01721

ENGINEERS & SURVEYORS:  APPLEWOOD SURVEY CO. LLC
 838 WASHINGTON STREET
 HOLLISTON, MASS. 01746
 TERENCE M. RYAN R.L.S. 37057

DATE: MARCH 18, 2025 SCALE: 1" = 20'

