

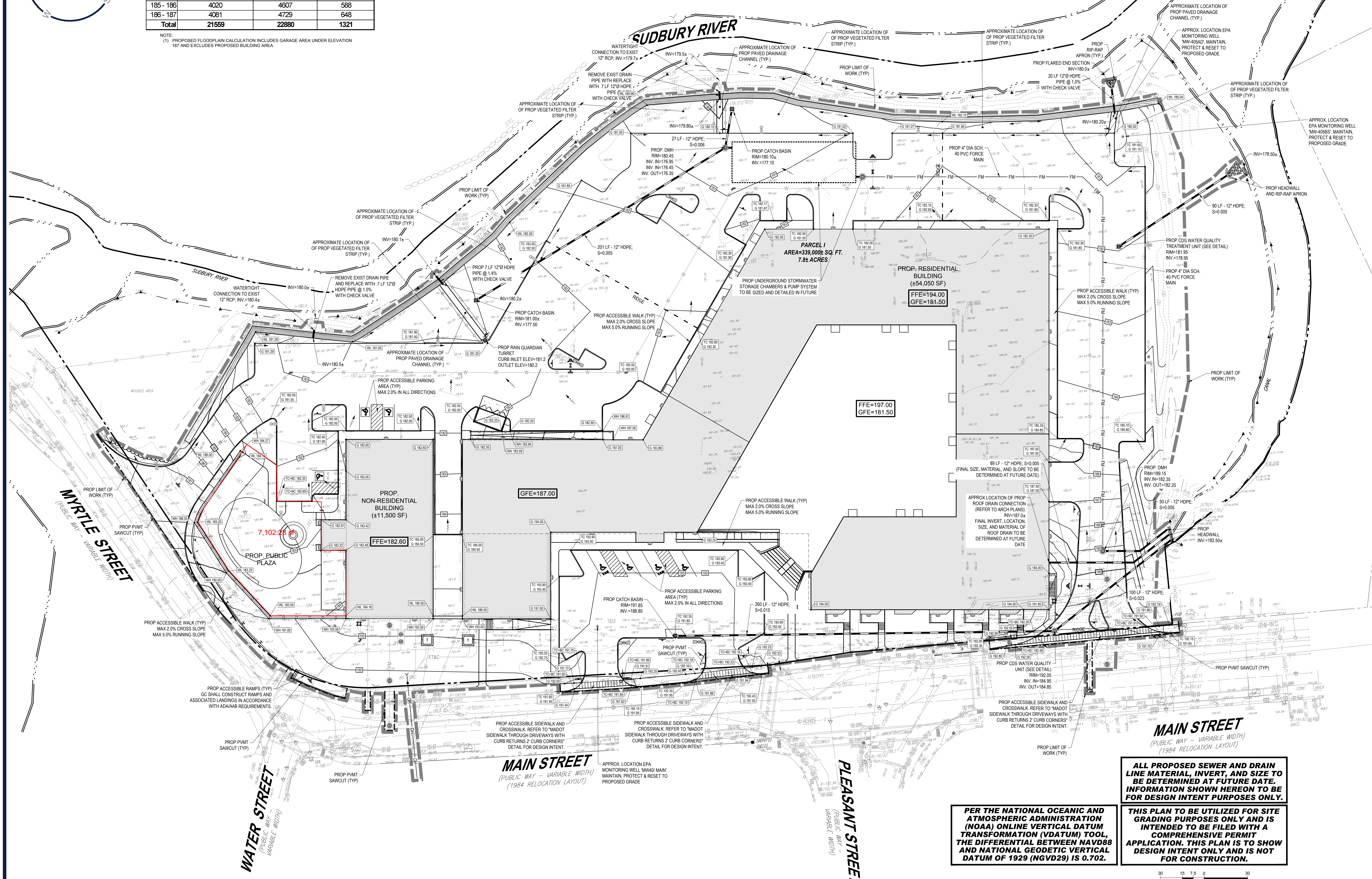

FLOOD STORAGE CALCULATIONS

Elevation Interval	Existing Volume Provided (Cy)	Proposed Volume Provided (Cy)	Net Volume Provided (Cy)
< 185	13459	13544	85
185 - 186	4020	4607	588
186 - 187	4081	4729	648
Total	21559	22880	1321

NOTE:
 (1) PROPOSED FLOODPLAIN CALCULATION INCLUDES GARAGE AREA UNDER ELEVATION 187 AND EXCLUDES PROPOSED BUILDING AREA.



BOHLER
 SITE CIVIL AND CONSULTING ENGINEERING
 PROGRAM MANAGEMENT
 LANDSCAPE ARCHITECTURE
 SUSTAINABLE DESIGN
 PERMITTING SERVICES
 TRANSPORTATION SERVICES

REVISIONS

REV	DATE	COMMENT	CHECKED BY
1	07/15/2024	ADDED EPA MONITORING WELLS	JAK
2	08/01/2024	COMPREHENSIVE PERMIT	CSE
3	02/25/2025	TRAFFIC COMMENTS	JAK
4	03/12/2025	RESPONSE TO HANCOCK COMMENTS	EKR
5	03/19/2025	REV'S TO DRIVEWAY & GARAGE	EKR
6	04/29/2025	RESPONSE TO MDM & HANCOCK	CSE

811
 Know what's below.
 Call before you dig.
 ALWAYS CALL 811
 It's fast. It's free. It's the law.

COMPREHENSIVE PERMIT PLANS

THIS DRAWING IS INTENDED FOR MUNICIPAL AND/OR AGENCY REVIEW AND APPROVAL. IT IS NOT INTENDED AS A CONSTRUCTION DOCUMENT UNLESS INDICATED OTHERWISE.

PROJECT No.: MAA230359-00-6A
 DRAWN BY: JAK
 DATE: 02/25/2025
 CAD ID: P-CIVL-PROP

PRELIMINARY SITE DEVELOPMENT PLANS

FOR
SLV ASHLAND, LLC
 PROPOSED 40B DEVELOPMENT "THE SANCTUARY AT ASHLAND MILLS"
 MAP: 14 | LOT: 128
 50 MAIN STREET
 TOWN OF ASHLAND MASSACHUSETTS

BOHLER
 352 TURNPIKE ROAD, 3rd FLOOR
 SOUTHBOROUGH, MA 01772
 Phone: (508) 480-9900
 www.BohlerEngineering.com

J.A. KUCICH
 John Kucich
 PROFESSIONAL ENGINEER
 MASS. REG. NO. 151330
 NEW HAMPSHIRE REG. NO. 15476
 CONN. REG. NO. 19177
 RHODE ISLAND REG. NO. 0616
 MAINE LICENSE NO. 12551

SHEET TITLE:
GRADING PLAN
 SHEET NUMBER:
C-401
 REVISION 6 - 04/29/2025

ALL PROPOSED SEWER AND DRAIN LINE MATERIAL, INVERT, AND SIZE TO BE DETERMINED AT FUTURE DATE. INFORMATION SHOWN HEREON TO BE FOR DESIGN INTENT PURPOSES ONLY.

PER THE NATIONAL OCEANIC AND ATMOSPHERIC ADMINISTRATION (NOAA) ONLINE VERTICAL DATUM TRANSFORMATION (VDATUM) TOOL, THE DIFFERENTIAL BETWEEN NAVD88 AND NATIONAL GEODETIC VERTICAL DATUM OF 1929 (NGVD29) IS 0.702.

THIS PLAN TO BE UTILIZED FOR SITE GRADING PURPOSES ONLY AND IS INTENDED TO BE FILED WITH A COMPREHENSIVE PERMIT APPLICATION. THIS PLAN IS TO SHOW DESIGN INTENT ONLY AND IS NOT FOR CONSTRUCTION.

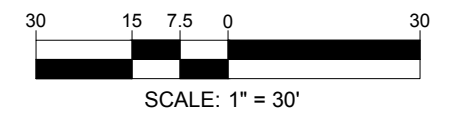

BOHLER ENGINEERING, INC. PROJECT: MAA230359-00-6A - LAYOUT C-401 GRADING PLAN