

REV. NO.	DATE	DESCRIPTION

OVERALL
LANDSCAPE
CONCEPT PLAN

DRAWN: --
CHECKED: --
SCALE: AS NOTED
DATE: --
L001

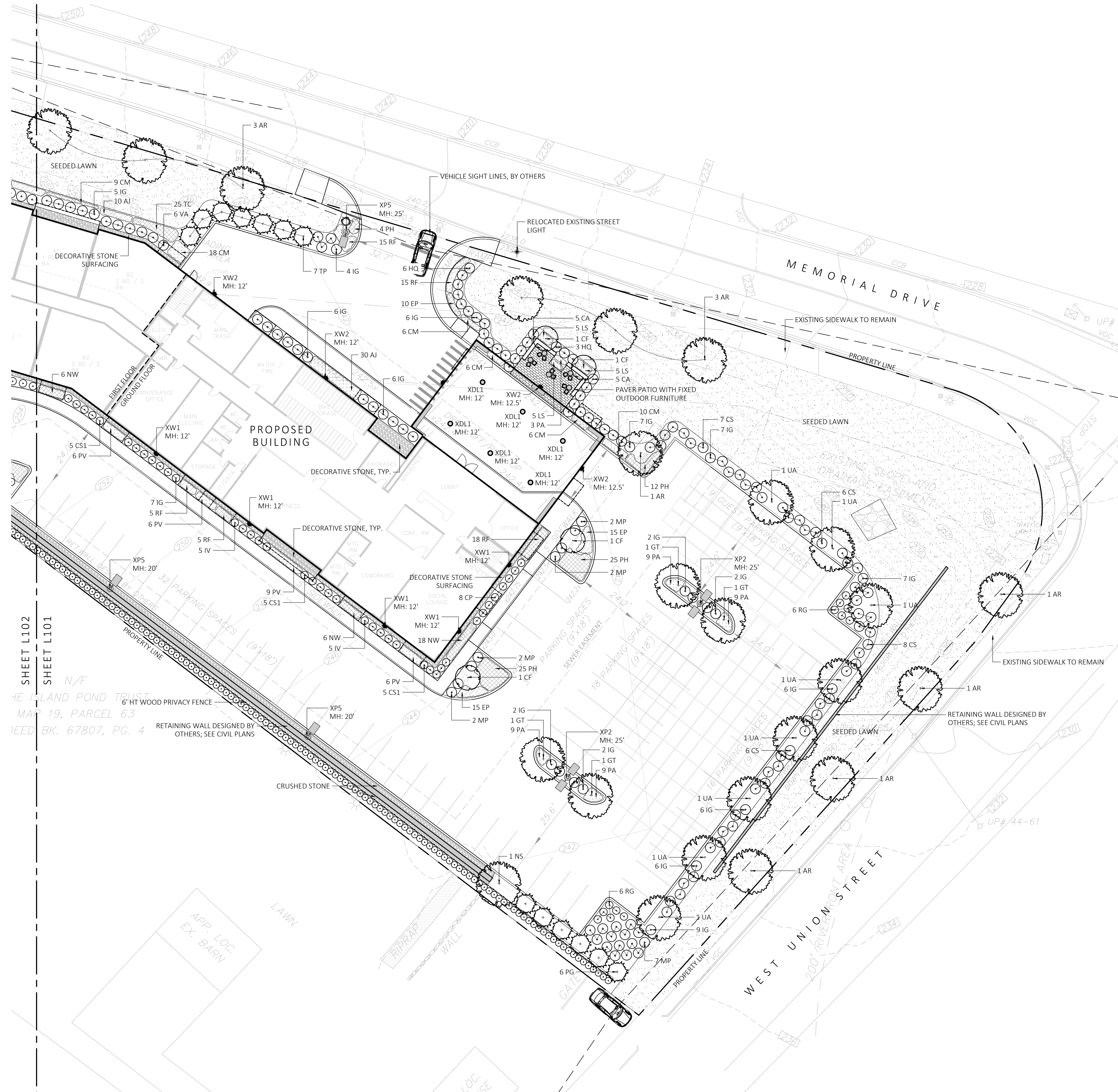

PLANTING NOTES

- DURING CONSTRUCTION, PROTECT ALL EXISTING SITE FEATURES, STRUCTURES AND UTILITIES.
- PLANTS SHALL BE TRUE TO SPECIES AND VARIETY SPECIFIED AND NURSERY GROWN IN ACCORDANCE WITH THE AMERICAN STANDARD FOR NURSERY STOCK UNDER CLIMATIC CONDITIONS SIMILAR TO THOSE IN THE LOCALITY OF THE PROJECT. SUBSTITUTIONS WILL BE PERMITTED ONLY IF APPROVED BY THE LANDSCAPE ARCHITECT.
- LANDSCAPE ARCHITECT APPROVAL IS REQUIRED BEFORE PLANT MATERIAL IS PURCHASED. LANDSCAPE ARCHITECT RESERVES THE RIGHT TO SEE ALL MATERIAL IN PERSON AT THE NURSERY. IF TRAVEL OUTSIDE OF MA IS REQUIRED, LANDSCAPE ARCHITECT'S TRAVEL COSTS SHALL BE PAID FOR BY THE CONTRACTOR.
- ALL EXPOSED BURLAP, WIRE BASKETS AND OTHER MATERIALS ATTACHED TO PLANTS SHALL BE REMOVED PRIOR TO PLANTING. CARE SHALL BE TAKEN NOT TO DISTURB THE ROOT BALL OF PLANTS.
- THOROUGHLY WATER ALL PLANTS IMMEDIATELY AFTER PLANTING.
- WHERE DISCREPANCIES IN QUANTITIES OCCUR, DRAWINGS SUPERCEDE PLANT NOTES AND SCHEDULE.
- TRANSPLANTING SHALL BE DONE IN ACCORDANCE WITH THE AMERICAN STANDARD FOR NURSERY STOCK.
- LOAM USED IN PLANT BEDS SHALL BE UNIFORM IN COMPOSITION, FREE FROM SUBSOIL, STONES LARGER THAN 1", NOXIOUS SEEDS AND SUITABLE FOR THE SUPPORT OF VEGETATIVE GROWTH. THE pH VALUE SHALL BE BETWEEN 5.5 AND 6.5.
- MULCH IN TREE AND SHRUB BEDS SHALL BE NATURAL, NATIVE HEMLOCK MULCH FREE OF GROWTH OR GERMINATION INHIBITING INGREDIENTS. SUBMIT SAMPLES FOR APPROVAL.
- LOCATIONS FOR PLANTS AND/OR OUTLINE OF AREAS TO BE PLANTED ARE TO BE STAKED OUT AT THE SITE FOR APPROVAL BY THE LANDSCAPE ARCHITECT.
- SOIL DEPTHS: a.) SHRUBS AND PERENNIAL BEDS: 18" MIN.; b.) GROUNDCOVER: 6" MIN.; c.) TREES: SEE DETAIL; d.) SOD/SEED: 6" MIN.
- PROVIDE A SUBSURFACE ROOTBALL ANCHOR BY PLATYPUS EARTH ANCHORS, SIZE FOR CALIPER

SYM	QTY	LATIN NAME	COMMON NAME	SIZE	NOTES
SHADE TREES					
AF	3	ACER X FREEMANII 'ARMSTRONG'	ARMSTRONG MAPLE	2.5"-3" CAL.	B&B, 6' CLEAR BRANCHING
AR	21	ACER RUBRUM	RED MAPLE	2.5"-3" CAL.	B&B, 6' CLEAR BRANCHING
CC	2	CERCIS CANADENSIS	EASTERN REDBUD	7'-8' HT	B&B, SPECIMEN
CF	4	CORNUS FLORIDA	FLOWERING DOGWOOD	7'-8' HT	B&B, SPECIMEN
GT	7	GLEDITSEA TRICANTHOS 'SKYLINE'	SKYLINE HONEYLOCUST	2.5"-3" CAL.	B&B, 6' CLEAR BRANCHING
NS	9	NYSSA SYLVATICA	BLACK TUPELO	2.5"-3" CAL.	B&B, 6' CLEAR BRANCHING
QB	6	QUERCUS BICOLOR	SWAMP WHITE OAK	2.5"-3" CAL.	B&B, 6' CLEAR BRANCHING
UA	10	ULMUS AMERICANA 'PRINCETON'	PRINCETON ELM	2.5"-3" CAL.	B&B, 6' CLEAR BRANCHING
EVERGREEN TREES					
PG	22	PICEA GLAUCA	WHITE SPRUCE	7'-8' HT	B&B
TP	12	THUJA PLICATA 'GREEN GIANT'	GREEN GIANT ARBORVITAE	7'-8' HT	B&B
SHRUBS AND GROUNDCOVERS					
CA	10	CLETHRA ALNIFOLIA 'HUMMINGBIRD'	SWEET PEPPERBUSH	5 GAL.	36" O.C., B&B
CP	8	COMPTONIA PEREGRINA	SWEET FERN	3 GAL.	36" O.C., B&B
CS	55	CORNUS SERICEA 'ARCTIC FIRE'	RED TWIG DOGWOOD	5 GAL.	48" O.C., B&B
CS1	15	CORNUS SERICEA 'KELSEY'	DWARF RED TWIG DOGWOOD	5 GAL.	30" O.C., B&B
HQ	25	HYDRANGEA QUERCIFOLIA	OAKLEAF HYDRANGEA	5 GAL.	48" O.C., B&B
JG	166	ILEX GLABRA 'SHAMROCK'	SHAMROCK INKBERRY	5 GAL.	48" O.C., B&B
JV	14	ILEX VERTICILLATA	WINTERBERRY HOLLY	5 GAL.	48" O.C., B&B
MP	66	MYRICA PENNSYLVANICA	BAYBERRY	5 GAL.	48" O.C., B&B
RG	51	RHUS AROMATICA 'GRO LOW'	FRAGRANT SUMAC	3 GAL.	36" O.C., B&B
VA	20	VIBURNUM ACERIFOLIUM	MAPLE LEAF VIBURNUM	5 GAL.	48" O.C., B&B
VD	11	VIBURNUM DENTATUM	ARROWWOOD VIBURNUM	5 GAL.	48" O.C., B&B
PERENNIALS AND ORNAMENTAL GRASSES					
AJ	73	ASTILBE JAPONICA 'MONTGOMERY'	MONTGOMERY ASTILBE	1 GAL.	18" O.C. CONTAINER
CM	70	CAREX MARROVILII	JAPANESE GRASS SEDGE	1 GAL.	18" O.C. CONTAINER
EP	82	ECHINACEA PURPUREA	PURPLE CONEFLOWER	1 GAL.	18" O.C. CONTAINER
LS	130	LIRIOPE SPICATA	LILY TURF	1 GAL.	18" O.C. CONTAINER
NW	57	NEPETA X FAASSENII 'WALKERS LOW'	CATMINT	1 GAL.	18" O.C. CONTAINER
PA	156	PEROVSKIA ATRIPLICIFOLIA 'LITTLE SPIRE'	LITTLE SPIRE RUSSIAN SAGE	1 GAL.	18" O.C. CONTAINER
PH	177	PENNISETUM ALOPECUROIDES 'HAMELIN'	HAMELIN FOUNTAIN GRASS	1 GAL.	18" O.C. CONTAINER
PV	214	PANICUM VIRGATUM 'SHEPHERD'S DAUGHTER'	SHEPHERD'S DAUGHTER	1 GAL.	30" O.C. CONTAINER
RF	166	RUDBECKIA FULGIDA 'GOLDSTURM'	BLACK EYED SUSAN	1 GAL.	18" O.C. CONTAINER
TC	51	TIARELLA CORDIFOLIA	FOAMFLOWER	1 GAL.	18" O.C. CONTAINER

LIGHTING SCHEDULE

SYMBOL	LABEL	MODEL	MOUNT	DESCRIPTION	OPTIONS	ARRANGEMENT
	XDL1	PRESOLITE LTR-6RD LTR-6RD-H-ML20L-DMT_LTR-6RF-T-ML2765T9WDS	RECESSED CEILING	COVERED ENTRY DOWNLIGHT	COLOR: BLACK	SINGLE
	XP1	BEACON RATIO SERIES RAR1-160-100-3K-4F	CONCRETE FOOTING	PARKING POLE LIGHT	COLOR: BLACK	SINGLE
	XP2	BEACON RATIO SERIES RAR1-160-100-3K-4F	CONCRETE FOOTING	PARKING POLE LIGHT	COLOR: BLACK	DOUBLE
	XP3	BEACON RATIO SERIES RAR1-160-100-3K7-4W-HSS-90-B	CONCRETE FOOTING	PARKING POLE LIGHT	COLOR: BLACK	SINGLE
	XP4	BEACON RATIO SERIES RAR-160-100-3K7-4W-BC	CONCRETE FOOTING	PARKING POLE LIGHT	COLOR: BLACK	SINGLE
	XP5	BEACON RATIO SERIES RAR-160-100-3K7-2-BC	CONCRETE FOOTING	PARKING POLE LIGHT	COLOR: BLACK	SINGLE
	XW1	BEACON RATIO WALL RWL1-48L-25-3K7-3-U	WALL MOUNT	WALL MOUNTED LIGHT	COLOR: BLACK	SINGLE
	XW2	BEACON RATIO WALL RWL1-48L-25-3K7-4W-U	WALL MOUNT	WALL MOUNTED LIGHT	COLOR: BLACK	SINGLE

CONTACT: ILLUMINATE, STEVE PRUDHOMME, (617) 947-8996; SUBMIT CUT SHEETS FOR APPROVAL



MDLA
LANDSCAPE ARCHITECTURE

MICHAEL D'ANGELO
LANDSCAPE ARCHITECTURE, LLC

840 SUMMER STREET
SUITE 201A
BOSTON, MA 02127
1.303.592.4788
www.m-d-la.com

55 WEST UNION STREET
ASHLAND, MASSACHUSETTS
NOT FOR CONSTRUCTION

STAMP
MASSACHUSETTS
REGISTERED LANDSCAPE ARCHITECT
NO. 4006
MICHAEL D'ANGELO

REV. NO. DATE DESCRIPTION

LANDSCAPE PLANTING AND LIGHTING ENLARGEMENT

DRAWN: --
CHECKED: --
SCALE: **L100**
AS NOTED
DATE: --

SHEET 00 OF 00

plot date: 7/14/2025

PLANTING NOTES

- DURING CONSTRUCTION, PROTECT ALL EXISTING SITE FEATURES, STRUCTURES AND UTILITIES.
- PLANTS SHALL BE TRUE TO SPECIES AND VARIETY SPECIFIED AND NURSERY GROWN IN ACCORDANCE WITH THE AMERICAN STANDARD FOR NURSERY STOCK UNDER CLIMATIC CONDITIONS SIMILAR TO THOSE IN THE LOCALITY OF THE PROJECT. SUBSTITUTIONS WILL BE PERMITTED ONLY IF APPROVED BY THE LANDSCAPE ARCHITECT.
- LANDSCAPE ARCHITECT APPROVAL IS REQUIRED BEFORE PLANT MATERIAL IS PURCHASED. LANDSCAPE ARCHITECT RESERVES THE RIGHT TO SEE ALL MATERIAL IN PERSON AT THE NURSERY. IF TRAVEL OUTSIDE OF MA IS REQUIRED, LANDSCAPE ARCHITECT'S TRAVEL COSTS SHALL BE PAID FOR BY THE CONTRACTOR.
- ALL EXPOSED BURLAP, WIRE BASKETS AND OTHER MATERIALS ATTACHED TO PLANTS SHALL BE REMOVED PRIOR TO PLANTING. CARE SHALL BE TAKEN NOT TO DISTURB THE ROOT BALL OF PLANTS.
- THOROUGHLY WATER ALL PLANTS IMMEDIATELY AFTER PLANTING.
- WHERE DISCREPANCIES IN QUANTITIES OCCUR, DRAWINGS SUPERCEDE PLANT NOTES AND SCHEDULE.
- TRANSPLANTING SHALL BE DONE IN ACCORDANCE WITH THE AMERICAN STANDARD FOR NURSERY STOCK.
- LOAM USED IN PLANT BEDS SHALL BE UNIFORM IN COMPOSITION, FREE FROM SUBSOIL, STONES LARGER THAN 1". NOXIOUS SEEDS AND SUITABLE FOR THE SUPPORT OF VEGETATIVE GROWTH. THE pH VALUE SHALL BE BETWEEN 5.5 AND 6.5.
- MULCH IN TREE AND SHRUB BEDS SHALL BE NATURAL, NATIVE HEMLOCK MULCH FREE OF GROWTH OR GERMINATION INHIBITING INGREDIENTS. SUBMIT SAMPLES FOR APPROVAL.
- LOCATIONS FOR PLANTS AND/OR OUTLINE OF AREAS TO BE PLANTED ARE TO BE STAKED OUT AT THE SITE FOR APPROVAL BY THE LANDSCAPE ARCHITECT.
- SOIL DEPTHS: a.) SHRUBS AND PERENNIAL BEDS: 18" MIN.; b.) GROUNDCOVER: 6" MIN.; c.) TREES: SEE DETAIL; d.) SOD/SEED: 6" MIN.
- PROVIDE A SUBSURFACE ROOTBALL ANCHOR BY PLATIPUS EARTH ANCHORS, SIZE FOR CALIPER

PLANT SCHEDULE					
SYM	QTY	LATIN NAME	COMMON NAME	SIZE	NOTES
SHADE TREES					
AF	3	ACER X FREEMANII 'ARMSTRONG'	ARMSTRONG MAPLE	2.5"-3" CAL.	B&B, 6' CLEAR BRANCHING
AR	21	ACER RUBRUM	RED MAPLE	2.5"-3" CAL.	B&B, 6' CLEAR BRANCHING
CC	2	CERCIS CANADENSIS	EASTERN REDBUD	7'-8' HT	B&B, SPECIMEN
CF	4	CORNUS FLORIDA	FLOWERING DOGWOOD	7'-8' HT	B&B, SPECIMEN
GT	7	GLIOMISIA TRICANTHOS 'SKYLINE'	SKYLINE HONEYLOCUST	2.5"-3" CAL.	B&B, 6' CLEAR BRANCHING
NS	9	NYSSA SYLVATICA	BLACK TUFLEO	2.5"-3" CAL.	B&B, 6' CLEAR BRANCHING
QB	6	QUERCUS BICOLOR	SWAMP WHITE OAK	2.5"-3" CAL.	B&B, 6' CLEAR BRANCHING
UA	10	ULMUS AMERICANA 'PRINCETON'	PRINCETON ELM	2.5"-3" CAL.	B&B, 6' CLEAR BRANCHING
EVERGREEN TREES					
PG	22	PICEA GLAUCA	WHITE SPRUCE	7'-8' HT	B&B
TP	12	THUJA PLICATA 'GREEN GIANT'	GREEN GIANT ARBORVITAE	7'-8' HT	B&B
SHRUBS AND GROUNDCOVERS					
CA	10	CLETHERA ALNIFOLIA 'HUMMINGBIRD'	SWEET PEPPERBUSH	5 GAL.	36" O.C., B&B
CP	8	COMPTONIA PEREGRINA	SWEET FERN	3 GAL.	36" O.C., B&B
CS	55	CORNUS SERICEA 'ARCTIC FIRE'	RED TWIG DOGWOOD	5 GAL.	48" O.C., B&B
CS1	15	CORNUS SERICEA 'KELSEY'	DWARF RED TWIG DOGWOOD	5 GAL.	30" O.C., B&B
HQ	25	HYDRANGEA QUERCIFOLIA	OAKLEAF HYDRANGEA	5 GAL.	48" O.C., B&B
IG	166	ILEX GLABRA 'SHAMROCK'	SHAMROCK INKBERRY	5 GAL.	48" O.C., B&B
IV	14	ILEX VERTICILLATA	WINTERBERRY HOLLY	5 GAL.	48" O.C., B&B
MP	66	MYRICA PENNSYLVANICA	BAYBERRY	5 GAL.	48" O.C., B&B
RG	51	RHUS AROMATICA 'GRO LOW'	FRAGRANT SUMAC	3 GAL.	36" O.C., B&B
VA	20	VIBURNUM ACERIFOLIUM	MAPLE LEAF VIBURNUM	5 GAL.	48" O.C., B&B
VD	11	VIBURNUM DENTATUM	ARROWWOOD VIBURNUM	5 GAL.	48" O.C., B&B
PERENNIALS AND ORNAMENTAL GRASSES					
AJ	73	ASTILBE JAPONICA 'MOUNTGOMERY'	MONTGOMERY ASTILBE	1 GAL.	18" O.C. CONTAINER
CM	70	CAREX MARROVII	JAPANESE GRASS SEDGE	1 GAL.	18" O.C. CONTAINER
EP	82	ECHINACEA PURPUREA	PURPLE CONEFLOWER	1 GAL.	18" O.C. CONTAINER
LS	130	LIRIOPE SPICATA	LILY TURF	1 GAL.	18" O.C. CONTAINER
NW	57	NEPETA X FAASSENII 'WALKERS LOW'	CATMINT	1 GAL.	18" O.C. CONTAINER
PA	156	PEROVSKIA ATRIPLICIFOLIA 'LITTLE SPIRE'	LITTLE SPIRE RUSSIAN SAGE	1 GAL.	18" O.C. CONTAINER
PH	177	PENNISETUM ALOPECUROIDES 'HAMEL'	HAMEL FOUNTAIN GRASS	1 GAL.	18" O.C. CONTAINER
PV	214	PANICUM VIRGATUM 'SHENANDOAH'	SWITCHGRASS	1 GAL.	30" O.C. CONTAINER
RF	166	RUDBECKIA FULGIDA 'GOLDSTURM'	BLACK EYED SUSAN	1 GAL.	18" O.C. CONTAINER
TC	51	TIARELLA CORDIFOLIA	FOAMFLOWER	1 GAL.	18" O.C. CONTAINER

LIGHTING SCHEDULE

SYMBOL	LABEL	MODEL	MOUNT	DESCRIPTION	OPTIONS	ARRANGEMENT
	XDL1	PRESCOLITE LTR-6RD LTR-6RD-H-ML20L-DMT_LTR-6RF-T-ML2765T9WDS	RECESSED CEILING	COVERED ENTRY DOWNLIGHT	COLOR: BLACK	SINGLE
	XP1	BEACON RATIO SERIES RAR1-160-100-3K-4F	CONCRETE FOOTING	PARKING POLE LIGHT	COLOR: BLACK	SINGLE
	XP2	BEACON RATIO SERIES RAR1-160-100-3K-4F	CONCRETE FOOTING	PARKING POLE LIGHT	COLOR: BLACK	DOUBLE
	XP3	BEACON RATIO SERIES RAR1-160-100-3K7-4W-HSS-90-B	CONCRETE FOOTING	PARKING POLE LIGHT	COLOR: BLACK	SINGLE
	XP4	BEACON RATIO SERIES RAR-160-100-3K7-4W-BC	CONCRETE FOOTING	PARKING POLE LIGHT	COLOR: BLACK	SINGLE
	XP5	BEACON RATIO SERIES RAR-160-100-3K7-2-BC	CONCRETE FOOTING	PARKING POLE LIGHT	COLOR: BLACK	SINGLE
	XW1	BEACON RATIO WALL RWL1-48L-25-3K7-3-U	WALL MOUNT	WALL MOUNTED LIGHT	COLOR: BLACK	SINGLE
	XW2	BEACON RATIO WALL RWL1-48L-25-3K7-4W-U	WALL MOUNT	WALL MOUNTED LIGHT	COLOR: BLACK	SINGLE

CONTACT: ILLUMINATE, STEVE PRUDHOMME, (617) 947-8996; SUBMIT CUT SHEETS FOR APPROVAL

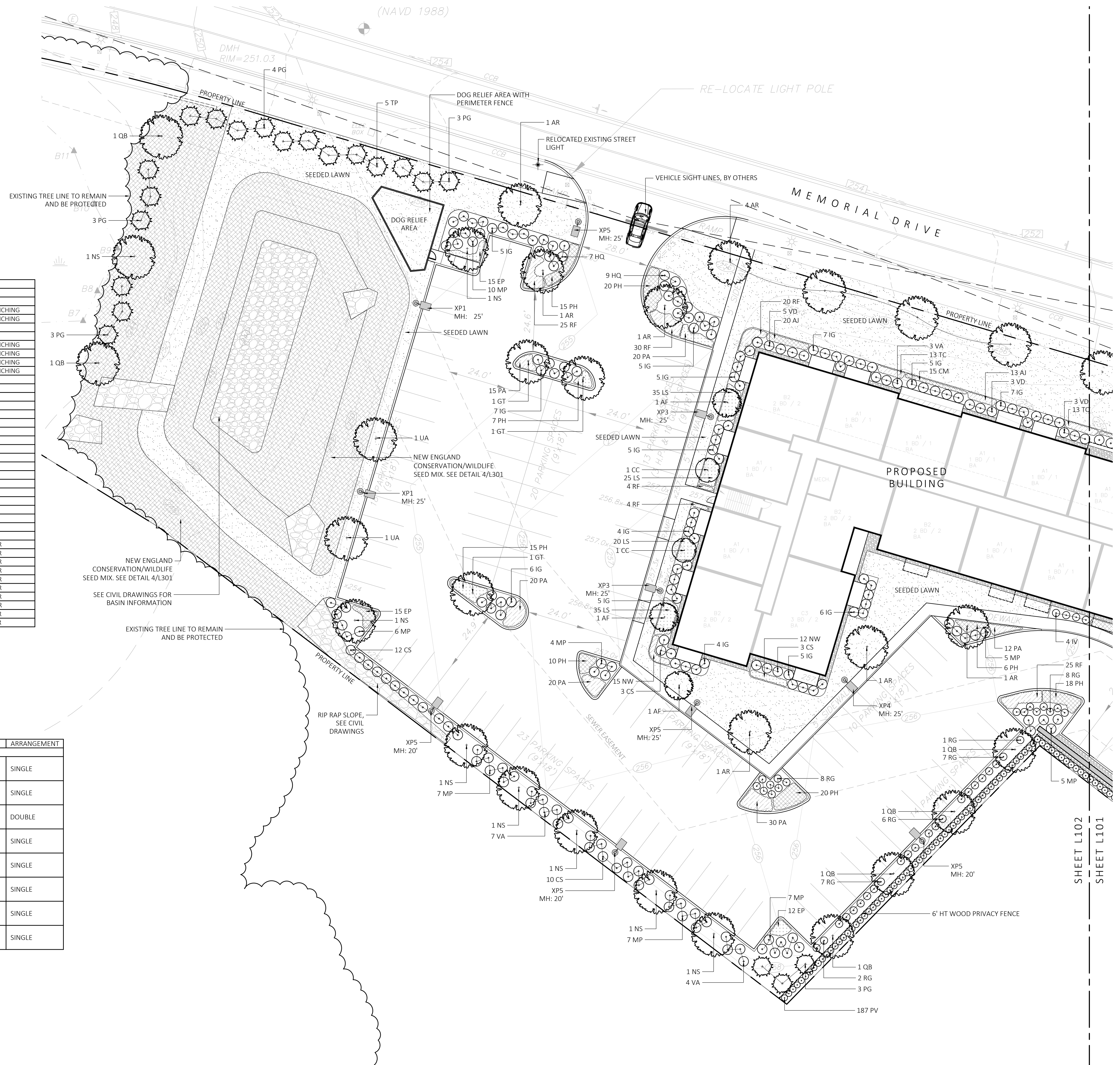

1 LANDSCAPE PLANTING AND LIGHTING ENLARGEMENT
1" = 10'-0"

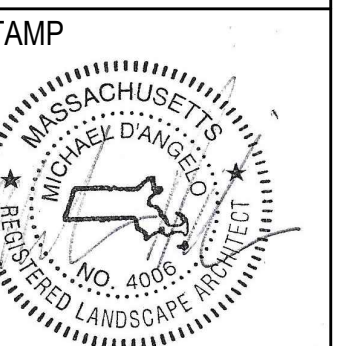
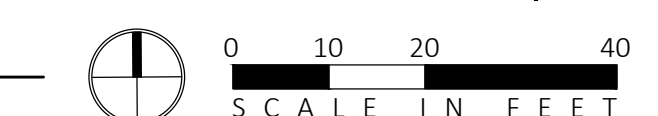

REV. NO.	DATE	DESCRIPTION

LANDSCAPE
PLANTING AND
LIGHTING
ENLARGEMENT

DRAWN: --
CHECKED: --
SCALE: AS NOTED
DATE: --

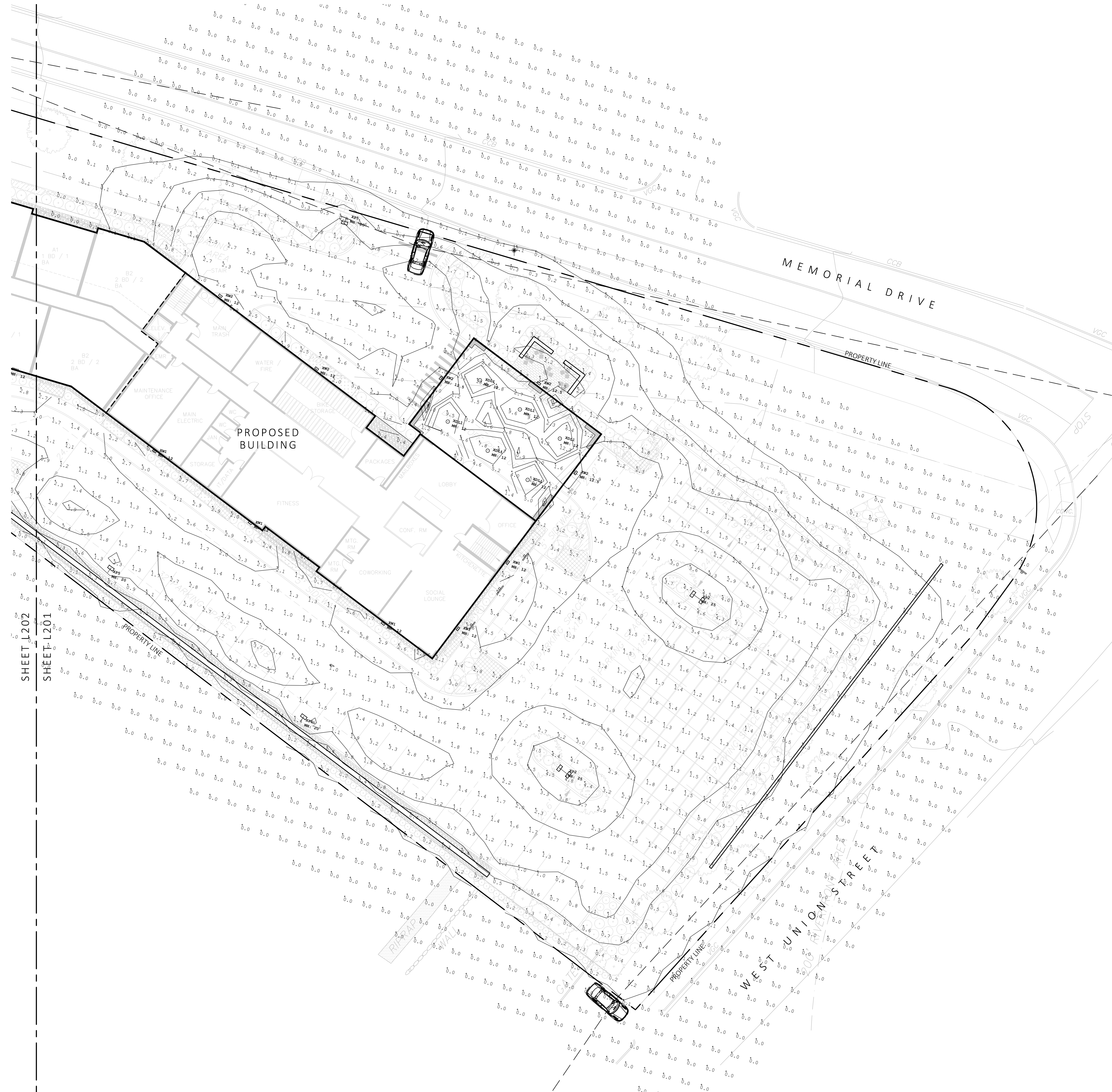

Luminaire Schedule						
Qty	Label	Arr. Watts	Arrangement	LLF	Description	
6	XDL1	36	SINGLE	0.900	LTR-6RD-H-ML20L-DMT_LTR-6RD-T-ML2765T9WDS	
2	XP1	97.2	SINGLE	0.900	RAR1-160L-100-3K-4F	
2	XP2	194.4	BACK-BACK	0.900	RAR1-160L-100-3K-4F	
2	XP3	90	SINGLE	0.900	RAR1-160L-100-3K7-4W-HSS-90-B	
1	XP4	90	SINGLE	1.000	RAR-1-160L-100-3K7-4W-BC	
8	XP5	90	SINGLE	0.900	RAR-1-160L-100-3K7-2-BC	
6	XW1	28	SINGLE	0.900	RWL1-48L-25-3K7-3-U	
5	XW2	28	SINGLE	0.900	RWL1-48L-25-3K7-4W-U	

Calculation Summary						
Label	Units	Avg	Max	Min	Avg/Min	Max/Min
Site	Fc	0.76	13.0	0.0	N.A.	N.A.

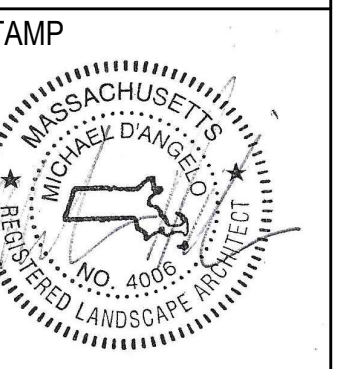

REV. NO.	DATE	DESCRIPTION

Luminaire Schedule					
Qty	Label	Arr. Watts	Arrangement	LLF	Description
6	XDL1	36	SINGLE	0.900	LTR-6RD-H-ML20L-DMT_LTR-6RD-T-ML2765T9WDS
2	XP1	97.2	SINGLE	0.900	RAR1-160L-100-3K-4F
2	XP2	194.4	BACK-BACK	0.900	RAR1-160L-100-3K-4F
2	XP3	90	SINGLE	0.900	RAR1-160L-100-3K7-4W-HSS-90-B
1	XP4	90	SINGLE	1.000	RAR-1-160L-100-3K7-4W-BC
8	XP5	90	SINGLE	0.900	RAR-1-160L-100-3K7-2-BC
6	XW1	28	SINGLE	0.900	RWL1-48L-25-3K7-3-U
5	XW2	28	SINGLE	0.900	RWL1-48L-25-3K7-4W-U

Calculation Summary						
Label	Units	Avg	Max	Min	Avg/Min	Max/Min
Site	Fc	0.76	13.0	0.0	N.A.	N.A.

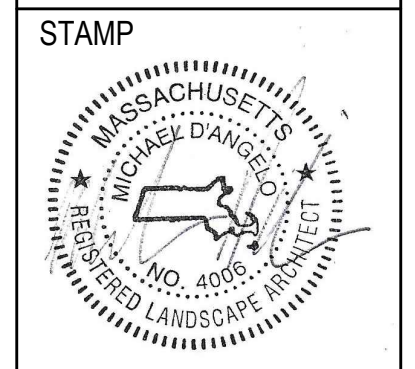

REV. NO.	DATE	DESCRIPTION

LANDSCAPE LIGHTING AND PHOTOMETRICS ENLARGEMENT

DRAWN: --
CHECKED: --
SCALE: AS NOTED
DATE: --
L201

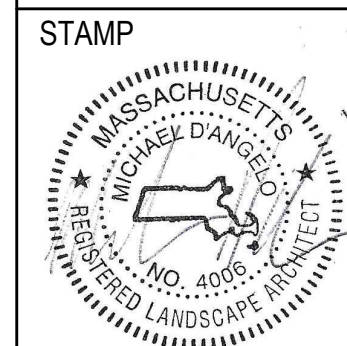

REV. NO.	DATE	DESCRIPTION

LANDSCAPE
DETAILS

DRAWN: --
CHECKED: --
SCALE: AS NOTED
DATE: --

L300

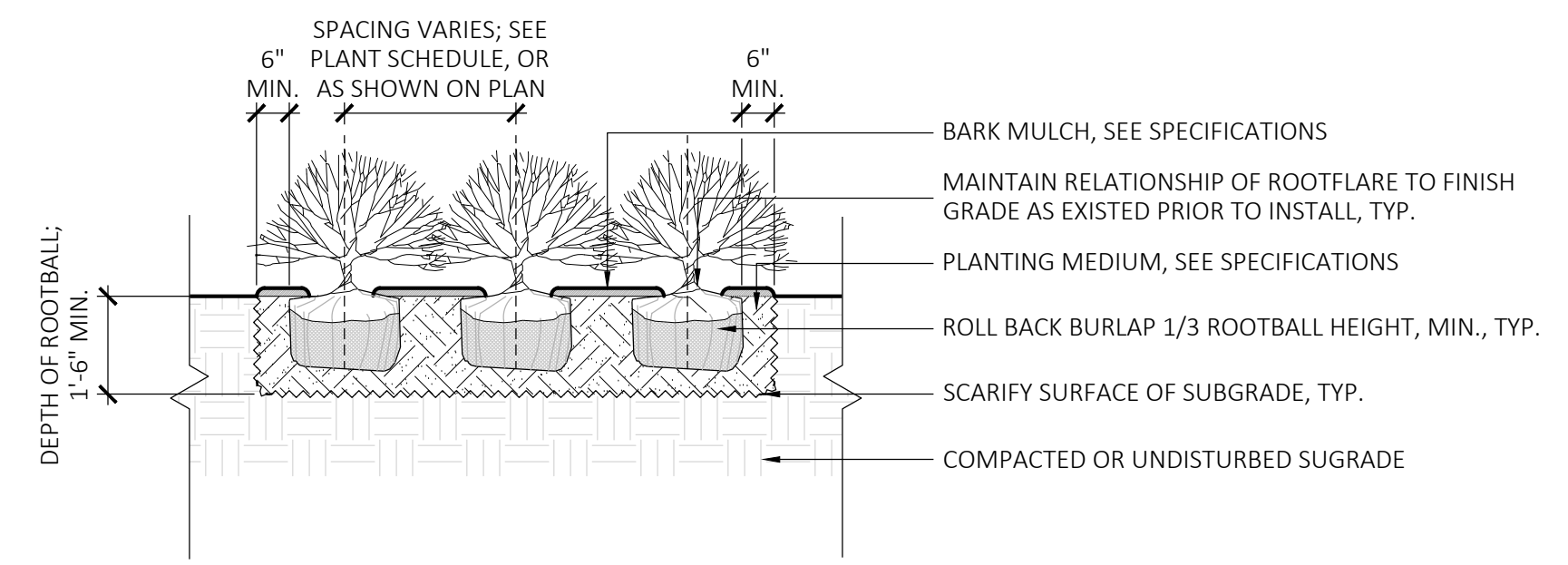

3 SHRUB PLANTING
SCALE: 3/8" = 1'-0"

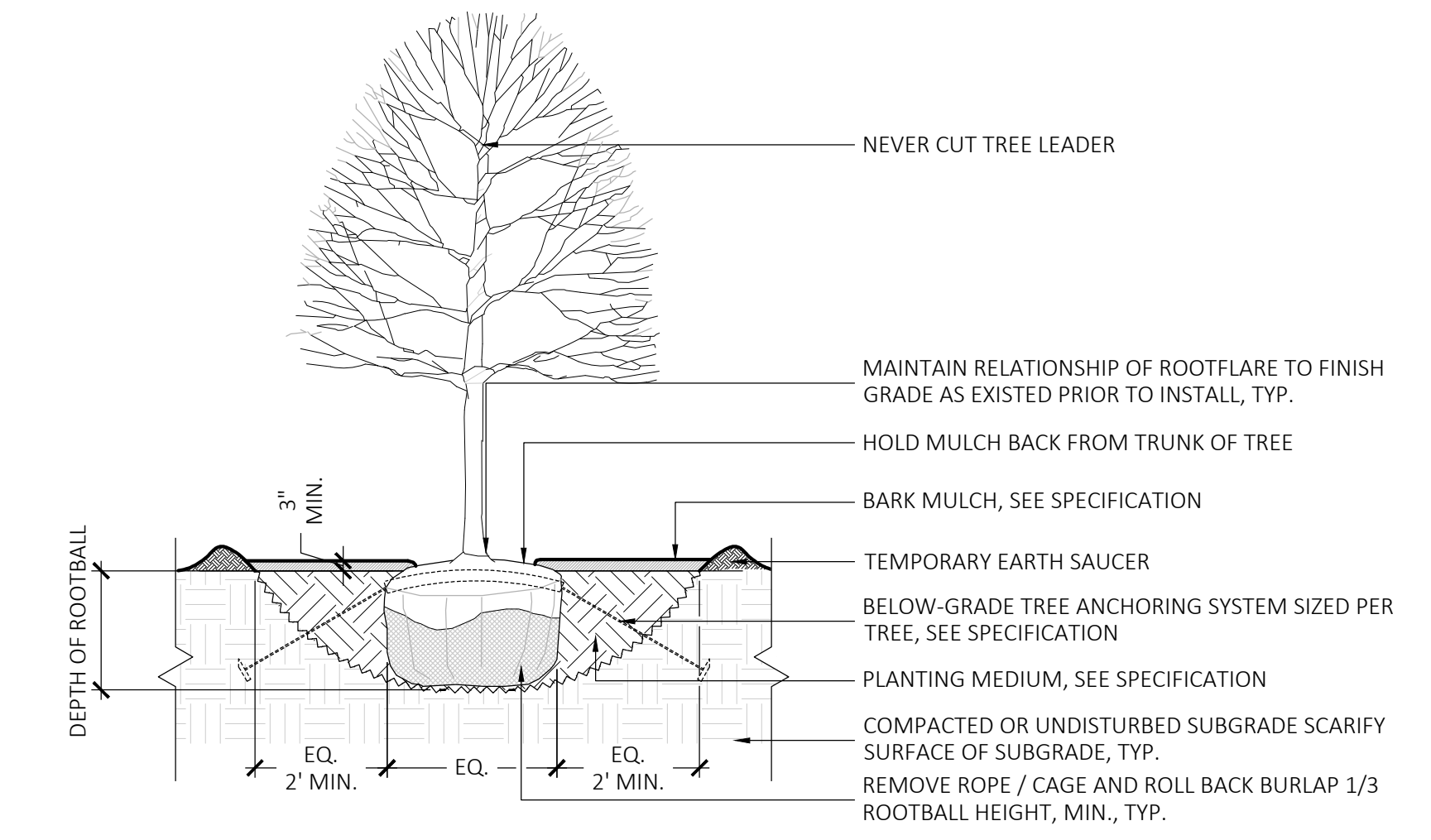

2 DECIDUOUS TREE PLANTING
SCALE: 1/4" = 1'-0"

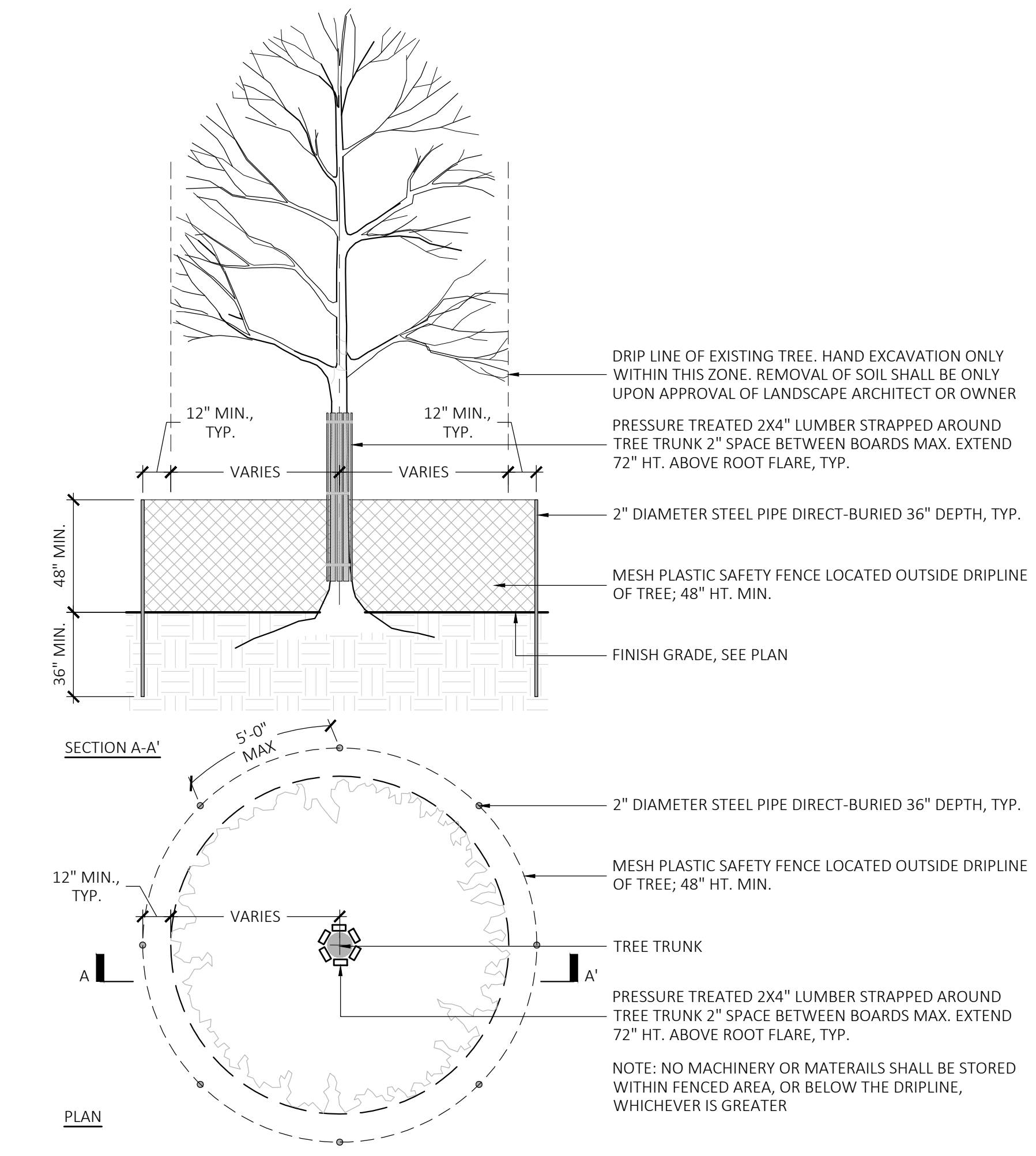

1 TREE PROTECTION
SCALE: 1/4" = 1'-0"

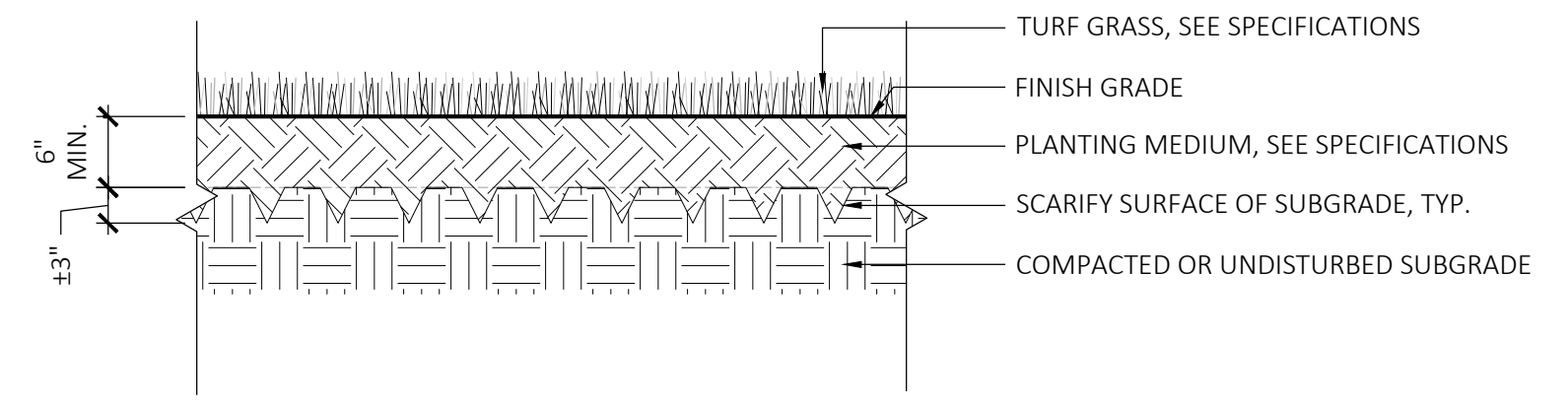

6 LAWN
SCALE: 3/8" = 1'-0"

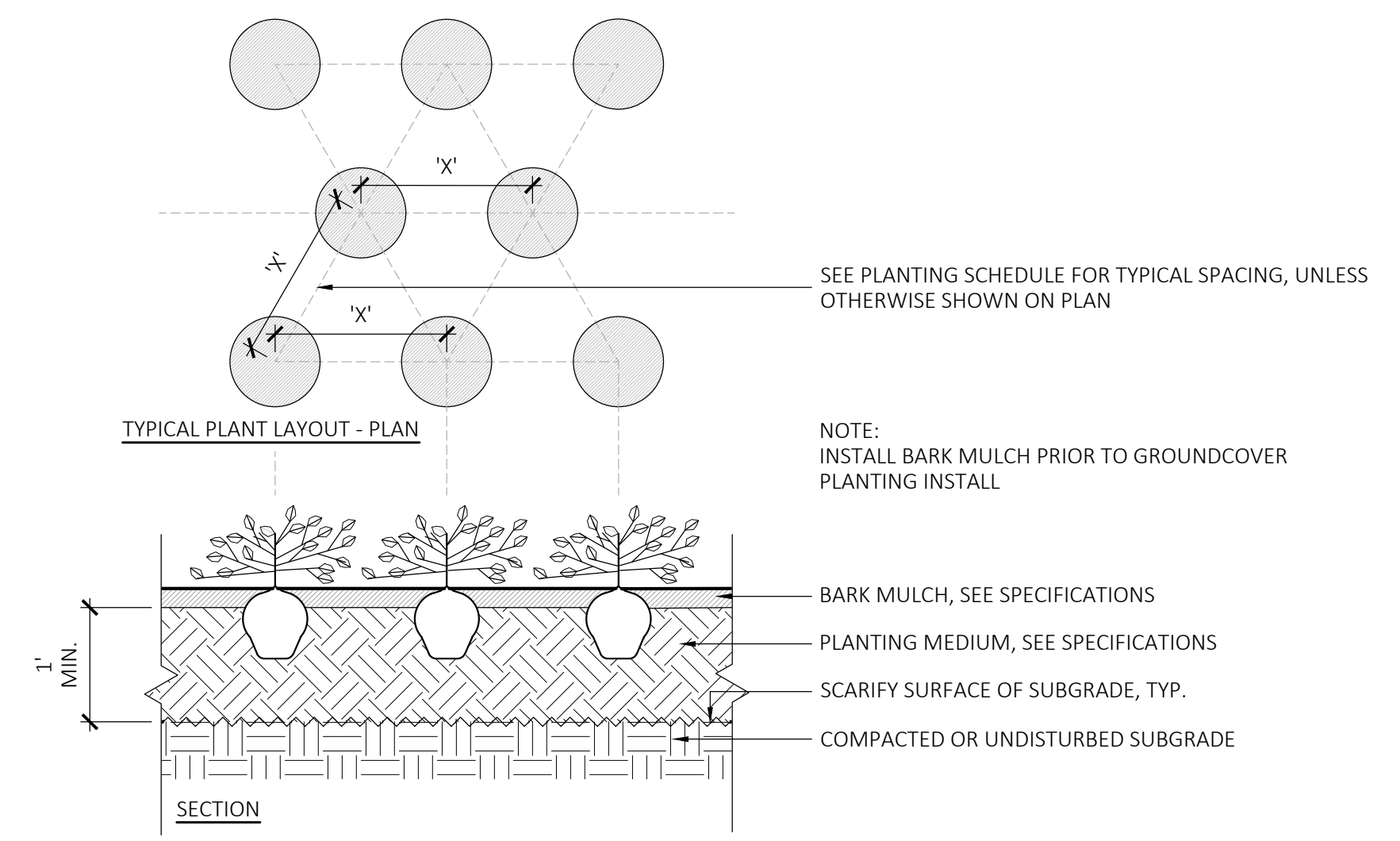

5 GROUNDCOVER PLANTING
SCALE: 3/8" = 1'-0"

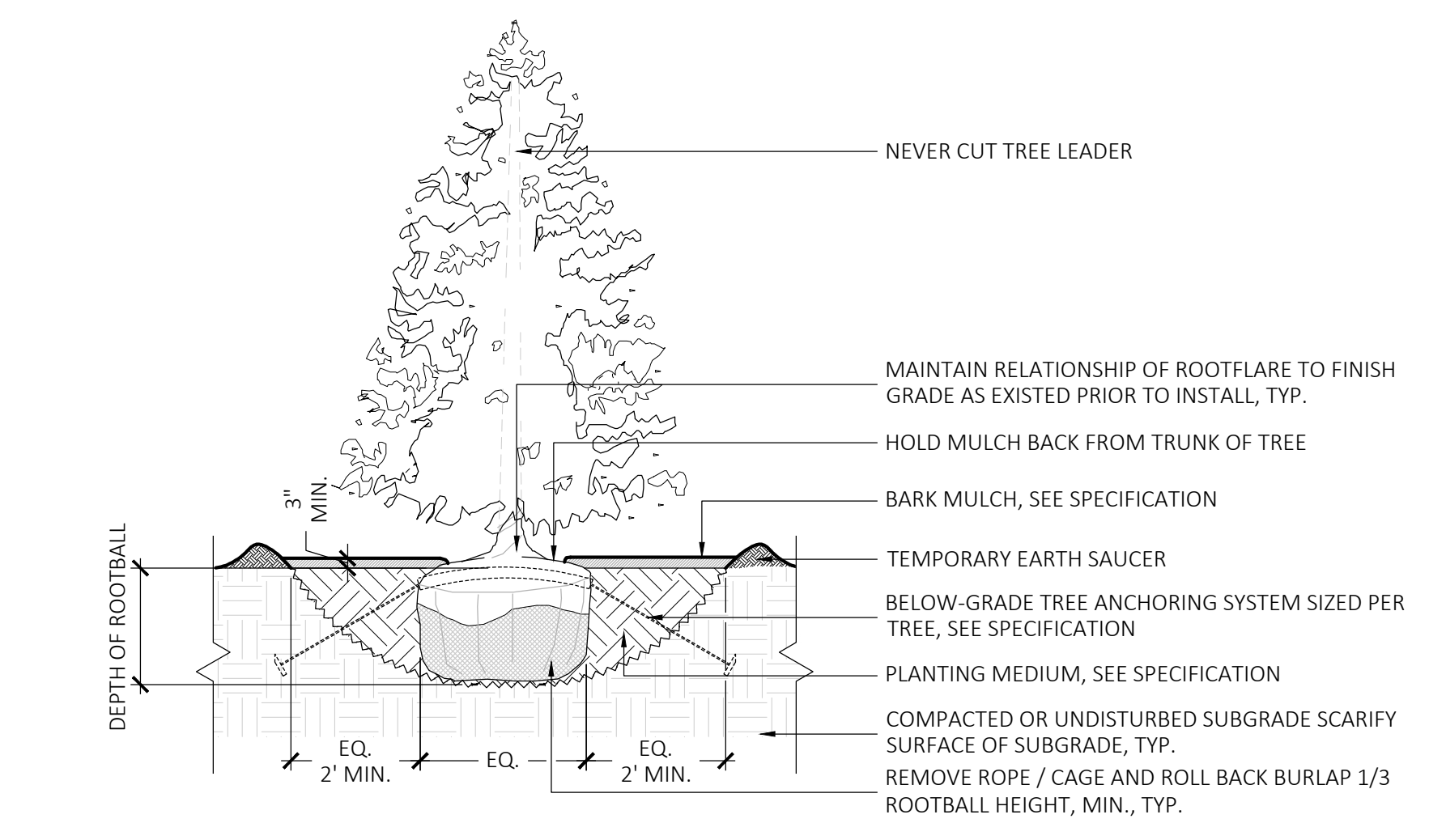

4 EVERGREEN TREE PLANTING
SCALE: 1/4" = 1'-0"