

CASE NO. 1
(CONNECTION AT FRONT)

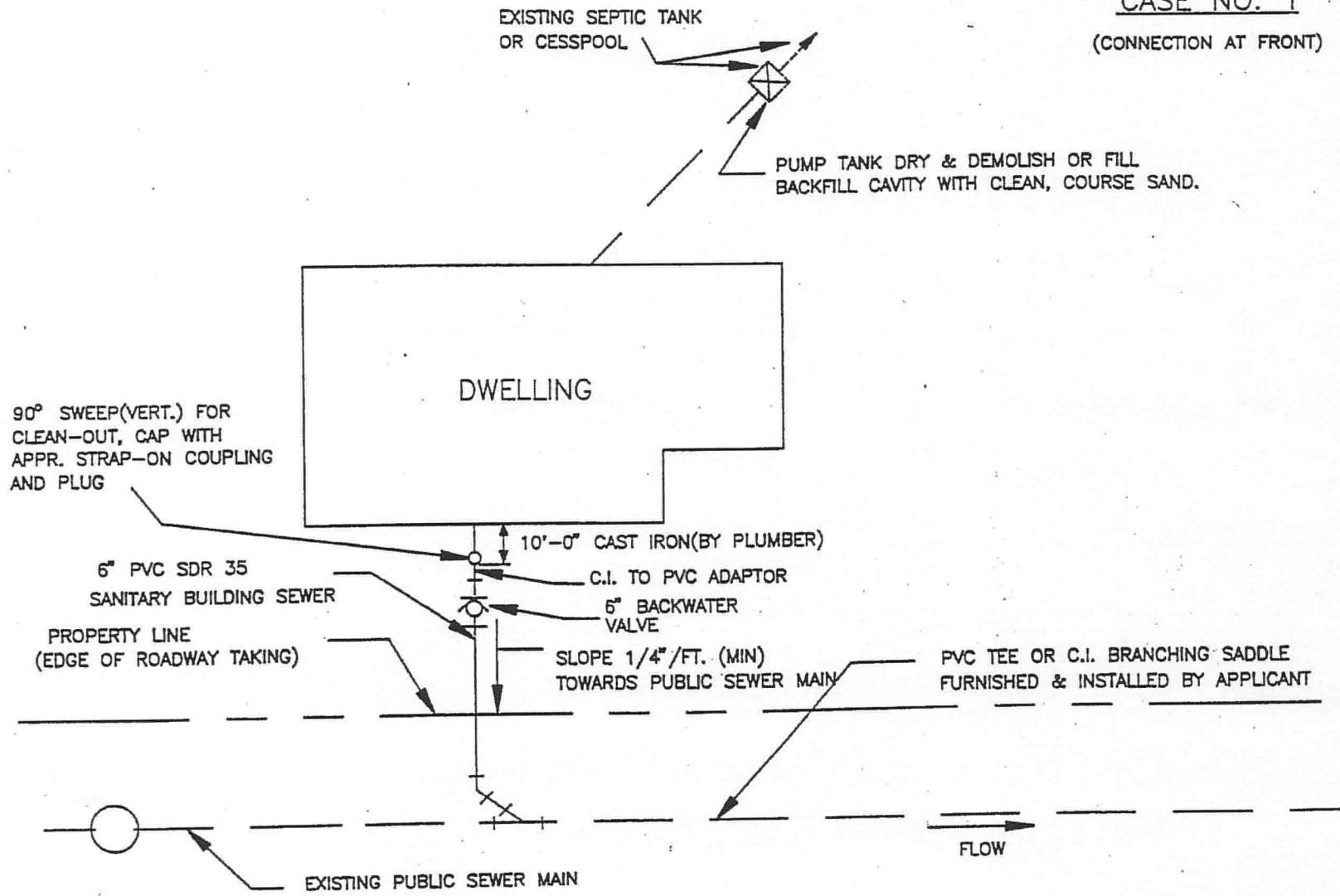

A-1

90° SWEEP (VERT.) FOR
CLEAN-OUT, CAP WITH
APPR. STRAP-ON COUPLING
AND PLUG

45° WYE
45° BEND

6" PVC SDR 35
SANITARY BUILDING
SEWER.

6" BACKWATER
VALVE

EXISTING SEPTIC TANK
OR CESSPOOL

PUMP TANK DRY & DEMOLISH OR FILL
BACKFILL CAVITY WITH CLEAN, COURSE SAND.

45° BEND
C.I. TO PVC ADAPTOR
10'-0" CAST IRON (BY PLUMBER)

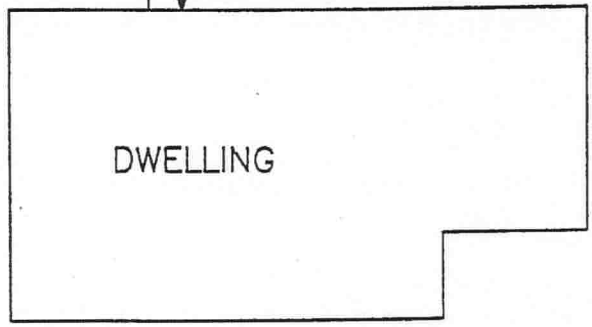

SLOPE 1/4" / FT. (MIN)
TOWARDS PUBLIC SEWER MAIN

PVC TEE OR C.I. BRANCHING SADDLE
FURNISHED & INSTALLED BY APPLICANT

PROPERTY LINE
(EDGE OF ROADWAY TAKING)

EXISTING PUBLIC SEWER MAIN

FLOW

CASE NO. 2
(CONNECTION AT REAR)

A-2

CASE NO. 3
(CONNECTION AT SIDE)

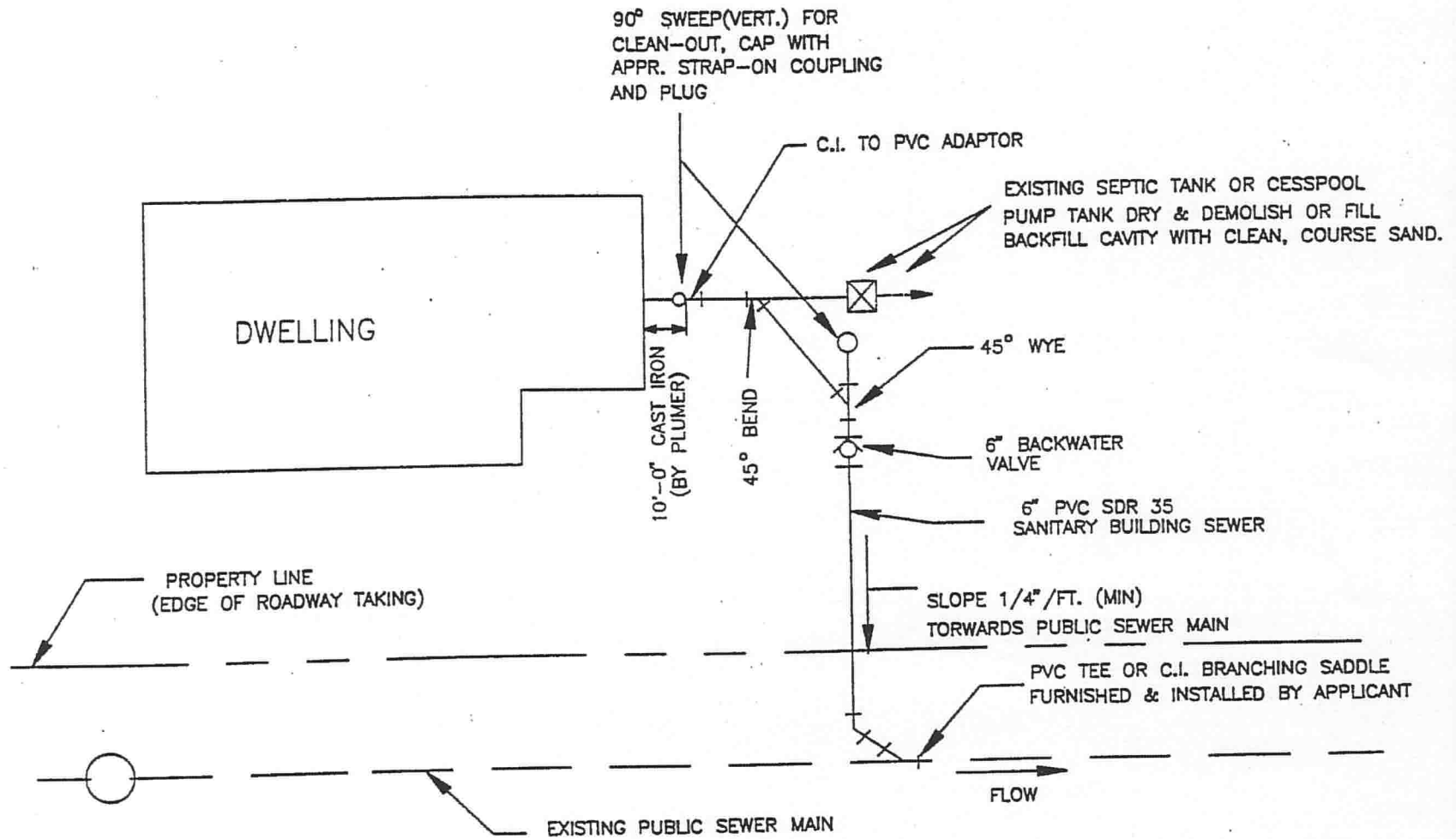

A-3